



**CITY OF GLENDALE, ARIZONA**

**DEVELOPMENT IMPACT FEE  
UNAUDITED  
STATEMENT OF REVENUES, EXPENDITURES AND CHANGES IN FUND BALANCE  
As of June 30, 2018**

**ACCOUNTING FOR THE COLLECTION AND USE OF DEVELOPMENT IMPACT FEES  
ANNUAL REPORT**



# Table of Contents

<b>Development Impact Fee Schedule</b>	<b>1</b>
<b>Unaudited Statement of Revenue, Expenditures, and Change in Fund Balance</b>	
<b>Development Impact Fee Account Summary – Government Funds</b>	<b>3</b>
<b>Detailed Development Impact Fee Expenditure Report – Government Funds</b>	<b>6</b>
<b>Development Impact Fee Account Summary – Enterprise Funds</b>	<b>8</b>
<b>Detailed Development Impact Fee Expenditure Report – Enterprise Funds</b>	<b>9</b>
<b>City of Glendale Map</b>	<b>Appendix A</b>

**TABLE 1: SCHEDULE OF COMMUNITY DEVELOPMENT IMPACT FEES**

<b>NON-UTILITY FEES FOR RESIDENTIAL DEVELOPMENT</b>					
<b>Residential - per Dwelling Unit in East Glendale</b>					
Type	Parks and Recreation	Streets	Police	Fire	Total
Single Unit	\$909	\$1,551	\$339	\$1,146	\$3,945
2+ Units per Structure	\$517	\$865	\$193	\$652	\$2,227
<b>Residential - per Dwelling Unit in West 101 Glendale</b>					
Type	Parks and Recreation	Streets	Police	Fire	Total
Single Unit	\$909	\$3,522	\$339	\$1,146	\$5,916
2+ Units per Structure	\$517	\$1,963	\$193	\$652	\$3,325
<b>NON-UTILITY FEES FOR NON-RESIDENTIAL DEVELOPMENT</b>					
<b>Non-Residential - per Thousand Square Feet of Floor Area in East Glendale</b>					
Type	Parks and Recreation	Streets	Police	Fire	Total
Industrial	\$23	\$308	\$12	\$129	\$472
Commercial	\$43	\$2,210	\$99	\$239	\$2,591
Institutional	\$30	\$883	\$36	\$166	\$1,115
Office & Other Services	\$101	\$957	\$39	\$563	\$1,660
<b>Non-Residential - per Thousand Square Feet of Floor Area in West 101 Glendale</b>					
Type	Parks and Recreation	Streets	Police	Fire	Total
Industrial	\$23	\$701	\$12	\$129	\$865
Commercial	\$43	\$5,017	\$99	\$239	\$5,398
Institutional	\$30	\$2,005	\$36	\$166	\$2,237
Office & Other Services	\$101	\$2,172	\$39	\$563	\$2,875
<b>Non-Residential - per Thousand Square Feet of Floor Area in West 303 Glendale</b>					
Type	Parks and Recreation	Streets	Police	Fire	Total
Industrial	\$0	\$1,154	\$12	\$129	\$1,295
Commercial	\$0	\$8,260	\$99	\$239	\$8,598
Institutional	\$0	\$3,301	\$36	\$166	\$3,503
Office & Other Services	\$0	\$3,575	\$39	\$563	\$4,177

**TABLE 1: SCHEDULE OF COMMUNITY DEVELOPMENT IMPACT FEES  
(Continued)**

<b>Utility Fees for all Development Types (per meter) in East Glendale and West 101 Glendale</b>			
<b>Meter Size</b>	<b>Water</b>	<b>Wastewater</b>	<b>Total</b>
0.75	\$2,761	\$1,944	\$4,705
1.00	\$4,607	\$3,243	\$7,850
1.50	\$9,183	\$6,462	\$15,645
2.00	\$14,695	\$10,341	\$25,036
3.00	\$29,413	\$20,696	\$50,109
4.00	\$45,950	\$32,331	\$78,281
6.00	\$91,867	\$64,637	\$156,504
8.00	\$146,991	\$103,420	\$250,411

**MAP OF SERVICE ZONES FOR CITY OF GLENDALE**

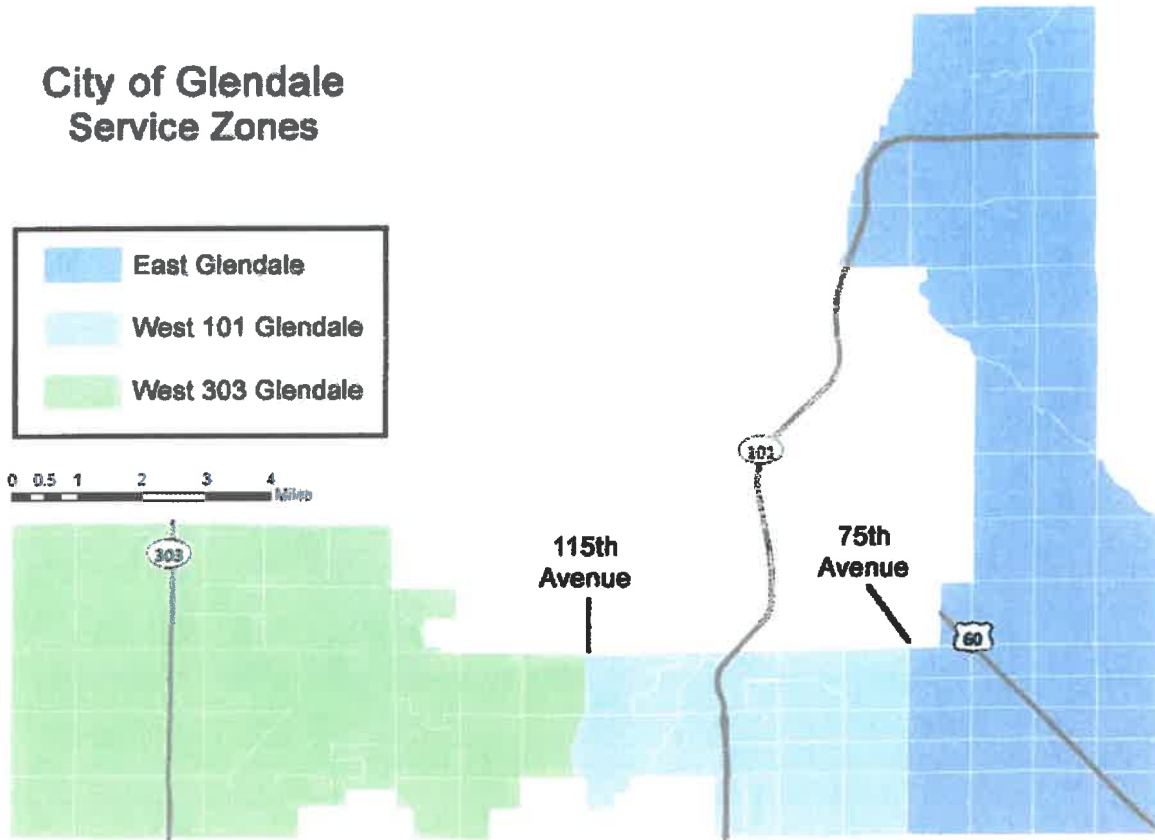

*Prepared for Glendale, Arizona by TischlerBise*

City of Glendale  
 Development Impact Fee Report  
 Unaudited - Statement of Revenue, Expenditures, and Change in Fund Balances  
 For Fiscal Year Ending June 30, 2018

Development Impact Fee Account Summary - Government Funds

	Fund 1380	Fund 1420	Fund 1440	Fund 1460	Fund 1480	Fund 1500	Fund 1520	Fund 1540	Fund 1560	Fund 1580	Fund 1600	Fund 1620	Total
	Library Buildings	Fire Prot. Facilities	Police Facilities	Parks-Citywide Parks	Parks-Citywide Recreation Areas	Library DIF	Parks-Citywide Open Space & Trails	Parks-Zone 1	Parks-Zone 2	Parks Zone 3	Roadway Improvements	General Government	
FY18 Annual Report Ending Balance	\$ 1,781,008.64	\$ 0.00	\$ 5,997.38	\$ 229,326.88	\$ 703,376.86	\$ 1,671,992.47	\$ 510,496.63	\$ 125,924.60	\$ 167,887.83	\$ 489.10	\$ 199,197.20	\$ 163,849.17	\$ 5,559,546.76
Revenue Adjustment	-	-	-	-	-	-	-	-	-	-	-	-	-
Expenditure Adjustment	-	-	-	-	-	-	-	-	-	-	-	-	-
<b>Beginning Balance at July 1, 2017</b>	<b>\$ 1,781,008.64</b>	<b>\$ 0.00</b>	<b>\$ 5,997.38</b>	<b>\$ 229,326.88</b>	<b>\$ 703,376.86</b>	<b>\$ 1,671,992.47</b>	<b>\$ 510,496.63</b>	<b>\$ 125,924.60</b>	<b>\$ 167,887.83</b>	<b>\$ 489.10</b>	<b>\$ 199,197.20</b>	<b>\$ 163,849.17</b>	<b>\$ 5,559,546.76</b>

Revenues

Total Amount of Impact Fees Collected	\$ -	\$ -	\$ -	\$ -	\$ -	\$ -	\$ -	\$ -	\$ -	\$ -	\$ -	\$ -	\$ -
Other Earnings	\$ -	\$ -	\$ -	\$ -	\$ -	\$ -	\$ -	\$ -	\$ -	\$ -	\$ -	\$ -	\$ -
Interest Earned on Each Account	\$ 21,600.03	-	\$ 81.29	\$ 2,781.29	\$ 7,988.26	\$ 19,290.41	\$ 6,188.06	\$ 1,525.78	\$ 2,032.35	\$ 6.29	\$ 2,289.99	\$ 1,983.71	\$ 65,767.46
<b>Total Revenues</b>	<b>\$ 21,600.03</b>	<b>\$ -</b>	<b>\$ 81.29</b>	<b>\$ 2,781.29</b>	<b>\$ 7,988.26</b>	<b>\$ 19,290.41</b>	<b>\$ 6,188.06</b>	<b>\$ 1,525.78</b>	<b>\$ 2,032.35</b>	<b>\$ 6.29</b>	<b>\$ 2,289.99</b>	<b>\$ 1,983.71</b>	<b>\$ 65,767.46</b>

Expenditures

	Fund 1380	Fund 1420	Fund 1440	Fund 1460	Fund 1480	Fund 1500	Fund 1520	Fund 1540	Fund 1560	Fund 1580	Fund 1600	Fund 1620	Total
	Library Buildings	Fire Prot. Facilities	Police Facilities	Parks-Citywide Parks	Parks-Citywide Recreation Areas	Library DIF	Parks-Citywide Open Space & Trails	Parks-Zone 1	Parks-Zone 2	Parks Zone 3	Roadway Improvements	General Government	
Total Capital Project Expenditures	\$ -	\$ -	\$ -	\$ -	\$ 204,549.34	\$ 353,798.79	\$ -	\$ -	\$ -	\$ -	\$ 20,556.85	\$ -	\$ 578,904.98

Bonds

Principal	\$ -	\$ -	\$ -	\$ -	\$ -	\$ -	\$ -	\$ -	\$ -	\$ -	\$ -	\$ -	\$ -
Interest	\$ -	\$ -	\$ -	\$ -	\$ -	\$ -	\$ -	\$ -	\$ -	\$ -	\$ -	\$ -	\$ -
Debt Service on Bonds (Total Paid)	\$ -	\$ -	\$ -	\$ -	\$ -	\$ -	\$ -	\$ -	\$ -	\$ -	\$ -	\$ -	\$ -
Capital Leases	\$ -	\$ -	\$ -	\$ -	\$ -	\$ -	\$ -	\$ -	\$ -	\$ -	\$ -	\$ -	\$ -
Principal	\$ -	\$ -	\$ -	\$ -	\$ -	\$ -	\$ -	\$ -	\$ -	\$ -	\$ -	\$ -	\$ -
Interest	\$ -	\$ -	\$ -	\$ -	\$ -	\$ -	\$ -	\$ -	\$ -	\$ -	\$ -	\$ -	\$ -
Payment on Capital Leases (Total Paid)	\$ -	\$ -	\$ -	\$ -	\$ -	\$ -	\$ -	\$ -	\$ -	\$ -	\$ -	\$ -	\$ -
Other Expenditures	\$ -	\$ -	\$ -	\$ -	\$ -	\$ -	\$ -	\$ -	\$ -	\$ -	\$ -	\$ 20,192.00	\$ 20,192.00
Advances from Other Funds	\$ -	\$ -	\$ -	\$ -	\$ -	\$ -	\$ -	\$ -	\$ -	\$ -	\$ -	\$ -	\$ -
<b>Total Expenditures</b>	<b>\$ -</b>	<b>\$ -</b>	<b>\$ -</b>	<b>\$ -</b>	<b>\$ 204,549.34</b>	<b>\$ 353,798.79</b>	<b>\$ -</b>	<b>\$ -</b>	<b>\$ -</b>	<b>\$ -</b>	<b>\$ 20,556.85</b>	<b>\$ 20,192.00</b>	<b>\$ 599,096.98</b>

FY18 End of Year Balance

	Fund 1380	Fund 1420	Fund 1440	Fund 1460	Fund 1480	Fund 1500	Fund 1520	Fund 1540	Fund 1560	Fund 1580	Fund 1600	Fund 1620	Total
	Library Buildings	Fire Prot. Facilities	Police Facilities	Parks-Citywide Parks	Parks-Citywide Recreation Areas	Library DIF	Parks-Citywide Open Space & Trails	Parks-Zone 1	Parks-Zone 2	Parks Zone 3	Roadway Improvements	General Government	
Beginning Balance	\$ 1,781,008.64	\$ 0.00	\$ 5,997.38	\$ 229,326.88	\$ 703,376.86	\$ 1,671,992.47	\$ 510,496.63	\$ 125,924.60	\$ 167,887.83	\$ 489.10	\$ 199,197.20	\$ 163,849.17	\$ 5,559,546.76
Total Revenues	\$ 21,600.03	-	\$ 81.29	\$ 2,781.29	\$ 7,988.26	\$ 19,290.41	\$ 6,188.06	\$ 1,525.78	\$ 2,032.35	\$ 6.29	\$ 2,289.99	\$ 1,983.71	\$ 65,767.46
Total Expenditures	\$ -	\$ -	\$ -	\$ -	\$ 204,549.34	\$ 353,798.79	\$ -	\$ -	\$ -	\$ -	\$ 20,556.85	\$ 20,192.00	\$ 599,096.98
<b>Ending Balance as of June 30, 2018</b>	<b>\$ 1,802,608.67</b>	<b>\$ 0.00</b>	<b>\$ 6,078.67</b>	<b>\$ 232,108.17</b>	<b>\$ 506,815.78</b>	<b>\$ 1,337,484.09</b>	<b>\$ 516,684.69</b>	<b>\$ 127,450.38</b>	<b>\$ 169,920.18</b>	<b>\$ 495.39</b>	<b>\$ 180,930.34</b>	<b>\$ 145,640.88</b>	<b>\$ 5,026,217.24</b>

City of Glendale  
 Development Impact Fee Report  
 Unaudited - Statement of Revenue, Expenditures, and Change in Fund Balances  
 For Fiscal Year Ending June 30, 2018

Development Impact Fee Account Summary - Government Funds

	Fund 1421	Fund 1441	Fund 1461	Fund 1481	Fund 1501	Fund 1541	Fund 1561	Fund 1581	Fund 1601	Total
Fire Protection Facilities				Citywide Recreation Fac	Libraries	Parks Dev Zone 1	Parks Dev Zone 2	Parks Dev Zone 3	Roadway Improvements	
	\$ -	\$ 417,543.90	\$ 107,226.01	\$ 107,226.01	\$ 205,192.23	\$ 53,076.73	\$ 13,030.67	\$ 13,721.00	\$ 2,078,016.81	\$ 2,995,033.36
Revenue Adjustment	\$ -	\$ -	\$ -	\$ -	\$ -	\$ -	\$ -	\$ -	\$ -	\$ -
Expenditure Adjustment	\$ -	\$ -	\$ -	\$ -	\$ -	\$ -	\$ -	\$ -	\$ -	\$ -
Beginning Balance at July 1, 2017	\$ -	\$ 417,543.90	\$ 107,226.01	\$ 107,226.01	\$ 205,192.23	\$ 53,076.73	\$ 13,030.67	\$ 13,721.00	\$ 2,078,016.81	\$ 2,995,033.36

Revenues

Total Amount of Impact Fees Collected	\$ -	\$ -	\$ -	\$ -	\$ -	\$ -	\$ -	\$ -	\$ -	\$ -
Other Earnings	\$ -	\$ -	\$ -	\$ -	\$ -	\$ -	\$ -	\$ -	\$ -	\$ -
Interest Earned on Each Account	\$ -	\$ 5,062.69	\$ 1,298.42	\$ 1,298.42	\$ 2,483.85	\$ 643.64	\$ 152.46	\$ 163.47	\$ 22,979.42	\$ 34,082.37
<b>Total Revenues</b>	\$ -	\$ 5,062.69	\$ 1,298.42	\$ 1,298.42	\$ 2,483.85	\$ 643.64	\$ 152.46	\$ 163.47	\$ 22,979.42	\$ 34,082.37

Expenditures

	Fund 1421	Fund 1441	Fund 1461	Fund 1481	Fund 1501	Fund 1541	Fund 1561	Fund 1581	Fund 1601	Total
Fire Protection Facilities				Citywide Recreation Fac	Libraries	Parks Dev Zone 1	Parks Dev Zone 2	Parks Dev Zone 3	Roadway Improvements	
	\$ -	\$ -	\$ -	\$ -	\$ -	\$ -	\$ -	\$ -	\$ 744,886.83	\$ 744,886.83
Total Capital Project Expenditures	\$ -	\$ -	\$ -	\$ -	\$ -	\$ -	\$ -	\$ -	\$ 744,886.83	\$ 744,886.83
Bonds	\$ -	\$ -	\$ -	\$ -	\$ -	\$ -	\$ -	\$ -	\$ -	\$ -
Principal	\$ -	\$ -	\$ -	\$ -	\$ -	\$ -	\$ -	\$ -	\$ -	\$ -
Interest	\$ -	\$ -	\$ -	\$ -	\$ -	\$ -	\$ -	\$ -	\$ -	\$ -
Debt Service on Bonds (Total Paid)	\$ -	\$ -	\$ -	\$ -	\$ -	\$ -	\$ -	\$ -	\$ -	\$ -
Capital Leases	\$ -	\$ -	\$ -	\$ -	\$ -	\$ -	\$ -	\$ -	\$ -	\$ -
Principal	\$ -	\$ -	\$ -	\$ -	\$ -	\$ -	\$ -	\$ -	\$ -	\$ -
Interest	\$ -	\$ -	\$ -	\$ -	\$ -	\$ -	\$ -	\$ -	\$ -	\$ -
Payment on Capital Leases (Total Paid)	\$ -	\$ -	\$ -	\$ -	\$ -	\$ -	\$ -	\$ -	\$ -	\$ -
Other Expenditures	\$ -	\$ -	\$ -	\$ -	\$ -	\$ -	\$ -	\$ -	\$ -	\$ -
Advances from Other Funds	\$ -	\$ -	\$ -	\$ -	\$ -	\$ -	\$ -	\$ -	\$ -	\$ -
<b>Total Expenditures</b>	\$ -	\$ -	\$ -	\$ -	\$ -	\$ -	\$ -	\$ -	\$ 744,886.83	\$ 744,886.83

FY18 End of Year Balance

	Fund 1421	Fund 1441	Fund 1461	Fund 1481	Fund 1501	Fund 1541	Fund 1561	Fund 1581	Fund 1601	Total
Fire Protection Facilities				Citywide Recreation Fac	Libraries	Parks Dev Zone 1	Parks Dev Zone 2	Parks Dev Zone 3	Roadway Improvements	
	\$ -	\$ 417,543.90	\$ 107,226.01	\$ 107,226.01	\$ 205,192.23	\$ 53,076.73	\$ 13,030.67	\$ 13,721.00	\$ 2,078,016.81	\$ 2,995,033.36
Beginning Balance	\$ -	\$ 5,062.69	\$ 1,298.42	\$ 1,298.42	\$ 2,483.85	\$ 643.64	\$ 152.46	\$ 163.47	\$ 22,979.42	\$ 34,082.37
Total Revenues	\$ -	\$ -	\$ -	\$ -	\$ -	\$ -	\$ -	\$ -	\$ 744,886.83	\$ 744,886.83
Total Expenditures	\$ -	\$ 422,606.59	\$ 108,524.43	\$ 108,524.43	\$ 207,676.08	\$ 53,720.37	\$ 13,188.13	\$ 13,984.47	\$ 1,356,109.40	\$ 2,284,228.90
<b>Ending Balance as of June 30, 2018</b>	\$ -	\$ 417,543.90	\$ 107,226.01	\$ 107,226.01	\$ 205,192.23	\$ 53,076.73	\$ 13,030.67	\$ 13,721.00	\$ 2,078,016.81	\$ 2,995,033.36

Development Impact Fee Account Summary - Government Funds

	Fund 1422	Fund 1423	Fund 1424	Fund 1442	Fund 1443	Fund 1444	Fund 1542	Fund 1543	Fund 1544	Fund 1602	Fund 1603	Fund 1604
	DIF-Fire Zone 1 East	DIF-Fire Zone 2 West 101	DIF-Fire Zone 3 West 303	DIF-Police Zone 1 East	DIF-Police Zone 2 West 101	DIF-Police Zone 3 West 303	DIF-Parks & Rec Zone 1 East	DIF-Parks & Rec Zone 2 West 101	DIF-Parks & Rec Zone 3 West 303	DIF-Streets Zone 1 East	DIF-Streets Zone 2 West 101	DIF-Streets Zone 3 West 303
FY17 Annual Report Ending Balance	\$ 495,894.63	\$ 832,796.47	\$ 2,188.91	\$ 133,232.02	\$ 197,203.13	\$ 201.85	\$ 278,893.25	\$ 506,842.16	\$ -	\$ 794,153.39	\$ 3,158,530.59	\$ 19,555.12
Revenue Adjustment	-	-	-	-	-	-	-	-	-	-	-	-
Expenditure Adjustment	-	-	-	-	-	-	-	-	-	-	-	-
<b>Beginning Balance at July 1, 2017</b>	<b>\$ 495,894.63</b>	<b>\$ 832,796.47</b>	<b>\$ 2,188.91</b>	<b>\$ 133,232.02</b>	<b>\$ 197,203.13</b>	<b>\$ 201.85</b>	<b>\$ 278,893.25</b>	<b>\$ 506,842.16</b>	<b>\$ -</b>	<b>\$ 794,153.39</b>	<b>\$ 3,158,530.59</b>	<b>\$ 19,555.12</b>

	Fund 1422	Fund 1423	Fund 1424	Fund 1442	Fund 1443	Fund 1444	Fund 1542	Fund 1543	Fund 1544	Fund 1602	Fund 1603	Fund 1604
	DIF-Fire Zone 1 East	DIF-Fire Zone 2 West 101	DIF-Fire Zone 3 West 303	DIF-Police Zone 1 East	DIF-Police Zone 2 West 101	DIF-Police Zone 3 West 303	DIF-Parks & Rec Zone 1 East	DIF-Parks & Rec Zone 2 West 101	DIF-Parks & Rec Zone 3 West 303	DIF-Streets Zone 1 East	DIF-Streets Zone 2 West 101	DIF-Streets Zone 3 West 303
Total Amount of Impact Fees Collected	\$ 338,036.19	\$ 165,996.63	\$ 2,601.87	\$ 70,076.55	\$ 21,993.96	\$ 242.02	\$ 149,734.27	\$ 55,103.22	\$ -	\$ 791,172.58	\$ 648,651.35	\$ 23,273.87
Other Earnings	-	-	-	-	-	-	-	-	-	550.00	-	-
Interest Earned on Each Account	\$ 8,260.09	\$ 11,272.80	\$ 51.00	\$ 2,014.88	\$ 2,573.98	\$ 3.00	\$ 4,186.80	\$ 6,578.69	\$ -	\$ 14,455.40	\$ 42,982.60	\$ 413.15
<b>Total Revenues</b>	<b>\$ 344,296.28</b>	<b>\$ 177,269.43</b>	<b>\$ 2,652.87</b>	<b>\$ 72,091.43</b>	<b>\$ 24,567.94</b>	<b>\$ 245.02</b>	<b>\$ 153,921.07</b>	<b>\$ 61,681.91</b>	<b>\$ -</b>	<b>\$ 806,177.98</b>	<b>\$ 691,633.95</b>	<b>\$ 23,687.02</b>

	Fund 1422	Fund 1423	Fund 1424	Fund 1442	Fund 1443	Fund 1444	Fund 1542	Fund 1543	Fund 1544	Fund 1602	Fund 1603	Fund 1604
	DIF-Fire Zone 1 East	DIF-Fire Zone 2 West 101	DIF-Fire Zone 3 West 303	DIF-Police Zone 1 East	DIF-Police Zone 2 West 101	DIF-Police Zone 3 West 303	DIF-Parks & Rec Zone 1 East	DIF-Parks & Rec Zone 2 West 101	DIF-Parks & Rec Zone 3 West 303	DIF-Streets Zone 1 East	DIF-Streets Zone 2 West 101	DIF-Streets Zone 3 West 303
Total Capital Project Expenditures	\$ -	\$ -	\$ -	\$ -	\$ -	\$ -	\$ -	\$ -	\$ -	\$ 180,253.42	\$ -	\$ -
Bonds	\$ -	\$ -	\$ -	\$ -	\$ -	\$ -	\$ -	\$ -	\$ -	\$ -	\$ -	\$ -
Principal	\$ -	\$ -	\$ -	\$ -	\$ -	\$ -	\$ -	\$ -	\$ -	\$ -	\$ -	\$ -
Interest	\$ -	\$ -	\$ -	\$ -	\$ -	\$ -	\$ -	\$ -	\$ -	\$ -	\$ -	\$ -
Debt Service on Bonds (Total Paid)	\$ -	\$ -	\$ -	\$ -	\$ -	\$ -	\$ -	\$ -	\$ -	\$ -	\$ -	\$ -
Capital Leases	\$ -	\$ -	\$ -	\$ -	\$ -	\$ -	\$ -	\$ -	\$ -	\$ -	\$ -	\$ -
Principal	\$ -	\$ -	\$ -	\$ -	\$ -	\$ -	\$ -	\$ -	\$ -	\$ -	\$ -	\$ -
Interest	\$ -	\$ -	\$ -	\$ -	\$ -	\$ -	\$ -	\$ -	\$ -	\$ -	\$ -	\$ -
Payment on Capital Leases (Total Paid)	\$ -	\$ -	\$ -	\$ -	\$ -	\$ -	\$ -	\$ -	\$ -	\$ -	\$ -	\$ -
Other Expenditures	\$ -	\$ -	\$ -	\$ -	\$ -	\$ -	\$ -	\$ -	\$ -	\$ -	\$ -	\$ -
Advances from Other Funds	\$ -	\$ -	\$ -	\$ -	\$ -	\$ -	\$ -	\$ -	\$ -	\$ -	\$ -	\$ -
<b>Total Expenditures</b>	<b>\$ -</b>	<b>\$ -</b>	<b>\$ -</b>	<b>\$ -</b>	<b>\$ -</b>	<b>\$ -</b>	<b>\$ -</b>	<b>\$ -</b>	<b>\$ -</b>	<b>\$ 180,253.42</b>	<b>\$ -</b>	<b>\$ -</b>

	Fund 1422	Fund 1423	Fund 1424	Fund 1442	Fund 1443	Fund 1444	Fund 1542	Fund 1543	Fund 1544	Fund 1602	Fund 1603	Fund 1604
	DIF-Fire Zone 1 East	DIF-Fire Zone 2 West 101	DIF-Fire Zone 3 West 303	DIF-Police Zone 1 East	DIF-Police Zone 2 West 101	DIF-Police Zone 3 West 303	DIF-Parks & Rec Zone 1 East	DIF-Parks & Rec Zone 2 West 101	DIF-Parks & Rec Zone 3 West 303	DIF-Streets Zone 1 East	DIF-Streets Zone 2 West 101	DIF-Streets Zone 3 West 303
Beginning Balance	\$ 495,894.63	\$ 832,796.47	\$ 2,188.91	\$ 133,232.02	\$ 197,203.13	\$ 201.85	\$ 278,893.25	\$ 506,842.16	\$ -	\$ 794,153.39	\$ 3,158,530.59	\$ 19,555.12
Total Revenues	\$ 344,296.28	\$ 177,269.43	\$ 2,652.87	\$ 72,091.43	\$ 24,567.94	\$ 245.02	\$ 153,921.07	\$ 61,681.91	\$ -	\$ 806,177.98	\$ 691,633.95	\$ 23,687.02
Total Expenditures	\$ -	\$ -	\$ -	\$ -	\$ -	\$ -	\$ -	\$ -	\$ -	\$ 180,253.42	\$ -	\$ -
<b>Ending Balance as of June 30, 2018</b>	<b>\$ 840,190.91</b>	<b>\$ 1,010,065.90</b>	<b>\$ 4,841.58</b>	<b>\$ 205,323.45</b>	<b>\$ 221,771.07</b>	<b>\$ 446.87</b>	<b>\$ 432,814.32</b>	<b>\$ 568,524.07</b>	<b>\$ -</b>	<b>\$ 1,420,077.95</b>	<b>\$ 3,850,164.54</b>	<b>\$ 43,242.14</b>





City of Glendale  
 Development Impact Fee Report  
 Unaudited - Statement of Revenue, Expenditures, and Change in Fund Balances  
 For Fiscal Year Ending June 30, 2018

Detailed Development Impact Fee Expenditure Report - Government Funds

Fund 1601

Roadway Improvements	Location	Capital Projects	Bonds	Capital Lease	Other	Total
Traffic Intersection Improvements	95th Ave & Camelback Rd	\$ 314,080.19	-	\$ -	-	\$ 314,080.19
Traffic Intersection Improvements	59th Ave & Olive, Glendale AZ	\$ 430,806.64	-	-	-	\$ 430,806.64
Total Expenditures		\$ 744,886.83	-	\$ -	-	\$ 744,886.83

Fund 1602

Streets Zone 1 East	Location	Capital Projects	Bonds	Capital Lease	Other	Total
Traffic Intersection Improvements	59th Ave & Olive, Glendale AZ	\$ 180,253.42	-	\$ -	-	\$ 180,253.42
Total Expenditures		\$ 180,253.42	-	\$ -	-	\$ 180,253.42

Fund 1620

General Government	Location	Capital Projects	Bonds	Capital Lease	Other	Total
Development Impact Fee Study	City of Glendale - 5850 W Glendale Ave, Glendale AZ	\$ -	-	\$ -	\$ 20,192.00	\$ 20,192.00
Total Expenditures		\$ -	-	\$ -	\$ 20,192.00	\$ 20,192.00

City of Glendale  
 Development Impact Fee Report  
 Unaudited - Statement of Revenue, Expenditures, and Change in Fund Balances  
 For Fiscal Year Ending June 30, 2018

Development Impact Fee Account Summary - Enterprise Funds

	Fund 2401 Water DIF Zone 1 East	Fund 2402 Water DIF Zone 2 West 101	Fund 2403 Water DIF Zone 3 West 303	Fund 2421 Sewer DIF Zone 1 East	Fund 2422 Sewer DIF Zone 2 West 101	Fund 2423 Sewer DIF Zone 3 West 303	Total
FY17 Annual Report Ending Balance	\$ 832,240.92	\$ 1,362,815.93	\$ -	\$ 455,651.58	\$ 862,236.67	\$ -	\$ 3,512,945.10
Revenue Adjustment	\$ -	\$ -	\$ -	\$ -	\$ -	\$ -	\$ -
Expenditure Adjustment	\$ -	\$ -	\$ -	\$ -	\$ -	\$ -	\$ -
Beginning Balance at July 1, 2017	\$ 832,240.92	\$ 1,362,815.93	\$ -	\$ 455,651.58	\$ 862,236.67	\$ -	\$ 3,512,945.10

Revenues

Total Amount of Impact Fees Collected	\$ 682,384.00	\$ 286,958.00	\$ -	\$ 410,006.00	\$ 168,911.00	\$ -	\$ 1,556,259.00
Other Earnings	\$ -	\$ -	\$ -	\$ -	\$ -	\$ -	\$ -
Interest Earned on Each Account	\$ 13,994.31	\$ 18,421.36	\$ -	\$ 7,830.63	\$ 11,589.79	\$ -	\$ 51,836.09
Total Revenues	\$ 696,378.31	\$ 315,379.36	\$ -	\$ 417,836.63	\$ 180,500.79	\$ -	\$ 1,610,095.09

Expenditures

	Fund 2401 Water DIF Zone 1 East	Fund 2402 Water DIF Zone 2 West 101	Fund 2403 Water DIF Zone 3 West 303	Fund 2421 Sewer DIF Zone 1 East	Fund 2422 Sewer DIF Zone 2 West 101	Fund 2423 Sewer DIF Zone 3 West 303	Total
Total Capital Project Expenditures	\$ -	\$ -	\$ -	\$ -	\$ -	\$ -	\$ -
Bonds	\$ -	\$ -	\$ -	\$ -	\$ -	\$ -	\$ -
Principal	\$ -	\$ -	\$ -	\$ -	\$ -	\$ -	\$ -
Interest	\$ -	\$ -	\$ -	\$ -	\$ -	\$ -	\$ -
Debt Service on Bonds (Total Paid)	\$ -	\$ -	\$ -	\$ -	\$ -	\$ -	\$ -
Capital Lease	\$ -	\$ -	\$ -	\$ -	\$ -	\$ -	\$ -
Principal	\$ -	\$ -	\$ -	\$ -	\$ -	\$ -	\$ -
Interest	\$ -	\$ -	\$ -	\$ -	\$ -	\$ -	\$ -
Payment on Capital Lease (Total Paid)	\$ -	\$ -	\$ -	\$ -	\$ -	\$ -	\$ -
Other Expenditures	\$ -	\$ -	\$ -	\$ -	\$ -	\$ -	\$ -
Advances from Other Funds	\$ -	\$ -	\$ -	\$ -	\$ -	\$ -	\$ -
Total Expenditures	\$ -	\$ -	\$ -	\$ -	\$ -	\$ -	\$ -

FY18 End of Year Balance

	Fund 2401 Water DIF Zone 1 East	Fund 2402 Water DIF Zone 2 West 101	Fund 2403 Water DIF Zone 3 West 303	Fund 2421 Sewer DIF Zone 1 East	Fund 2422 Sewer DIF Zone 2 West 101	Fund 2423 Sewer DIF Zone 3 West 303	Total
Total Beginning Balance	\$ 832,240.92	\$ 1,362,815.93	\$ -	\$ 455,651.58	\$ 862,236.67	\$ -	\$ 3,512,945.10
Total Revenues	\$ 696,378.31	\$ 315,379.36	\$ -	\$ 417,836.63	\$ 180,500.79	\$ -	\$ 1,610,095.09
Total Expenditures	\$ -	\$ -	\$ -	\$ -	\$ -	\$ -	\$ -
Ending Balance as of June 30, 2018	\$ 1,528,619.23	\$ 1,678,195.29	\$ -	\$ 873,488.21	\$ 1,042,737.46	\$ -	\$ 5,123,040.19





# APPENDIX

A

# Glendale Parks and Recreation Facilities

## SMALL AND NEIGHBORHOOD PARKS (UP TO 10 ACRES)

- 1 Acoma Park, 53rd Ave. & Acoma Rd.
- 2 Arrowhead Lakes Park, 56th Ave. & Mohawk Ln.
- 3 Bicentennial Park, 71st Ave. & Missouri Ave.
- 4 Butler Park, 57th Ave. & Alice Ave.
- 5 Carmel Park, 52nd Dr. & Oraibi Dr.
- 6 Cholla Park, 53rd Ave. & Cholla St.
- 7 Clavelito Park, 53rd Ave. & Ocotillo Rd.
- 8 Country Gables Park, 52nd Ave. & Country Gables Dr.
- 9 Delicias Park, 48th Dr. & Orangewood Ave.
- 10 Desert Garden Park, 69th Ave. & Ocotillo Rd.
- 11 Desert Mirage Park, 87th Ave. & Maryland Ave.
- 12 Desert Rose Park, 63rd Ave. & Kings Ave.
- 13 Desert Valley Park, 61st Ave. & Sweetwater Ave.
- 14 Discovery Park, 79th Ave. & Maryland Ave.
- 15 Dos Lagos Park, 63rd Ave. & Utopia Rd.
- 16 El Barrio Park, 54th Ave. & Ocotillo Rd.
- 17 Gardenwood Park, 53rd Ave. & Orangewood Ave.
- 18 Greenbriar Park, 69th Ave. & Greenbriar Dr.
- 19 Greenway Granada Park, 73rd Ave. & Greenway Rd.
- 20 Heritage Park, 55th Ave. & Mountain View Rd.
- 21 Hillcrest Park, 71st Ave. & Hillcrest Blvd.
- 22 Horizon Park, 47th Ave. & Diana Ave.
- 23 Kings Park, 53rd Ave. & Kings Ave.
- 24 Lawrence Park, 62nd Ave. & Lawrence Rd.
- 25 Lions Park, 63rd Ave. & Haywood Ave.
- 26 Manistee Ranch Park, 52nd Ave. & Northern Ave.
- 27 Mary Silva Park, 45th Ave. & Marshall Ave.
- 28 Maryland Lakes Park, 47th Ave. & Maryland Ave.
- 29 Memmingen Park, 49th Ave. & Cholla St.
- 30 Mission Park, 47th Ave. & Sunnyslope Ln.
- 31 Mondo Park, 57th Ave. & Hatcher Rd.
- 32 Montara Park, 64th Ave. & Becker Ln.
- 33 Murphy Park, 58th Ave. & Glendale Ave.
- 34 Myrtle Park, 55th Ave. & Myrtle Ave.
- 35 New World Park, 48th Dr. & Golden Ln.
- 36 Oasis Park, 79th Ave. and Utopia Rd.
- 37 Ocotillo Rose Park, 61st Ave. & Keim Rd.
- 38 Orangewood Vista Park, 79th Ave. & Orangewood Ave.
- 39 Pasadena Park, 87th Ave. & Pasadena Ave.
- 40 Paseo Neighborhood Park, 14099 N. 63rd Ave.
- 41 Plaza Rosa Park, 61st Ave. & Maryland Ave.
- 42 Rovey Park, 47th Ave. & Rovey Ave.
- 43 Sands Park, 55th Ave. & Orangewood Ave.
- 44 Sierra Verde Park, 71st Ave. & Rose Garden Ln.
- 45 Sonorita Park, 58th Dr. & Market St.
- 46 Sunnyside Park, 63rd Ave. & Cholla St.
- 47 Sunset Park, 45th Ave. and Mountain View Rd.
- 48 Sunset Palms Park, 54th Ave. & Sweetwater Ave.
- 49 Sunset Ridge Park, 87th Ave. & Missouri Ave.
- 50 Sunset Vista Park, 64th Ave. & Villa Rita Dr.
- 51 Sycamore Grove Park, 86th Ln. & Emil Rovey Pkwy.
- 52 Tarrington Ranch Park, 63rd Ave. & Butler Dr.
- 53 Tierra Buena Park, 57th Ave. & Tierra Buena Ln.
- 54 Utopia Park, 72nd Ave. & Utopia Rd.
- 55 Windsor Park, 63rd Ave. & Windsor Blvd.

## REGIONAL PARKS (25 TO 200 ACRES)

- 64 Foothills Park, 57th Ave. & Union Hills Dr.
- 65 Glendale Heroes Regional Park, 83rd Ave. & Bethany Home Rd.
- 66 Grand Canal Linear Park,
- 67 75th Ave. & Camelback to Bethany Home & New River
- 68 Sahuaro Ranch Park, 59th Ave. & Mountain View Rd.
- 69 Skunk Creek Linear Park,
- 70 51st Ave. & Utopia to 73rd Ave. & Greenway
- 71 Thunderbird Paseo Park,
- 72 51st Ave. & Cactus to 72nd Ave. & Greenway

## CONSERVATION PARKS (200+ ACRES)

- 70 Thunderbird Conservation Park, 59th Ave. & Pinnacle Peak Rd. (main entrance)

## RECREATION CENTERS

- A Community Center North Building, 14075 N. 59th Ave.
- B Foothills Recreation & Aquatics Center, 5600 W. Union Hills Dr.
- C Glendale Adult Center, 5970 W. Brown St.
- D Glendale Community Center, 5401 W. Ocotillo Rd.
- E O'Neil Building, 6448 W. Missouri Ave.
- F Rose Lane Building, 5003 W. Marlette Ave.

## POOLS

- B Foothills Recreation & Aquatics Center, 5600 W. Union Hills Dr.
- F Rose Lane Aquatics Center, 5003 W. Marlette Ave.

## GOLF COURSES

- G Glen Lakes Municipal Golf Course, 5450 W. Northern Ave.
- H Desert Mirage Golf Course, 8710 W. Maryland Ave.

## ADDITIONAL FACILITIES

- 64 Foothills Sk8 Court, 57th Dr. & Union Hills Dr.
- 65 X-Court, 59th Ave. & Berridge Ln.
- 65 Splash Pad, 59th Ave. & Berridge Ln.
- I Glendale Amphitheater, 5850 W. Glendale Ave.
- J Bridle Path, 51st Ave. from Cactus to Potter Dr.
- K Elsie McCarthy Sensory Garden, 55th Ave. & Morten Ave.
- L Paseo Racquet Center, 6268 W. Thunderbird Rd.
- M Glendale Youth Sports Complex, 6220 N. 91st Ave.
- N Myrtle Avenue Cultural Gateway, Myrtle Ave. & Grand Ave.

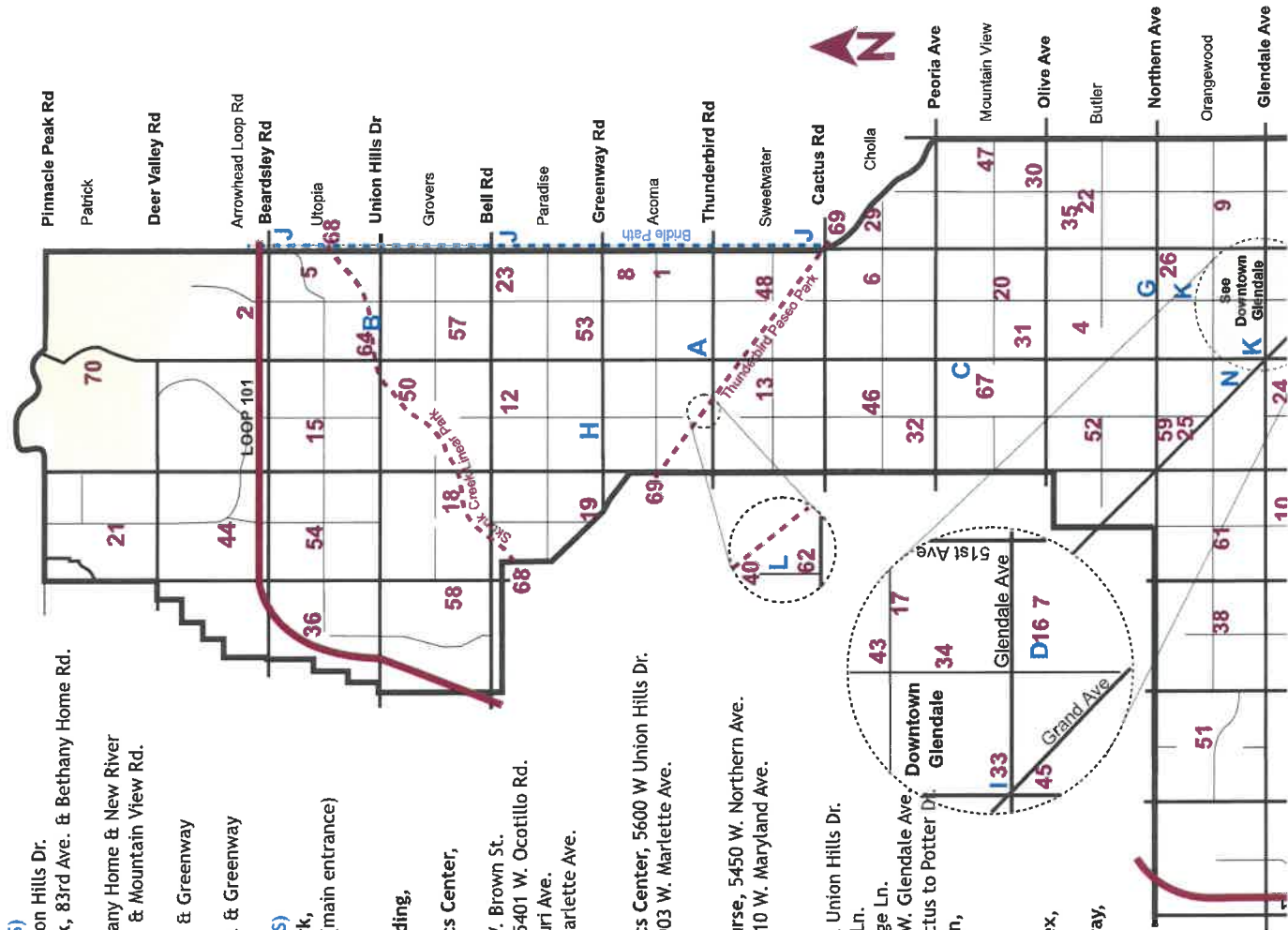



**COMMUNITY PARKS (10 TO 25 ACRES)**

- 56a Bonsall Park North, 59th Ave. & Bethany Home Rd.
- 56b Bonsall Park South, 59th Ave. & Bethany Home Rd.
- 57 Chapparal Park, 57th Ave. & Greenbriar Dr.
- 58 Hidden Meadows Park, 76th Ave. & St. John Rd.
- 59 Northern Horizon Park, 63rd Ave. & Northern Ave.
- 60 O'Neil Park, 64th Ave. & Missouri Ave.
- 61 Orangewood Park, 72nd Ave. & Orangewood Ave.
- 62 Paseo Racquet Center & Park, 63rd Ave. & Thunderbird Rd.
- 63 Rose Lane Park, 51st Ave. & Marlette Ave.

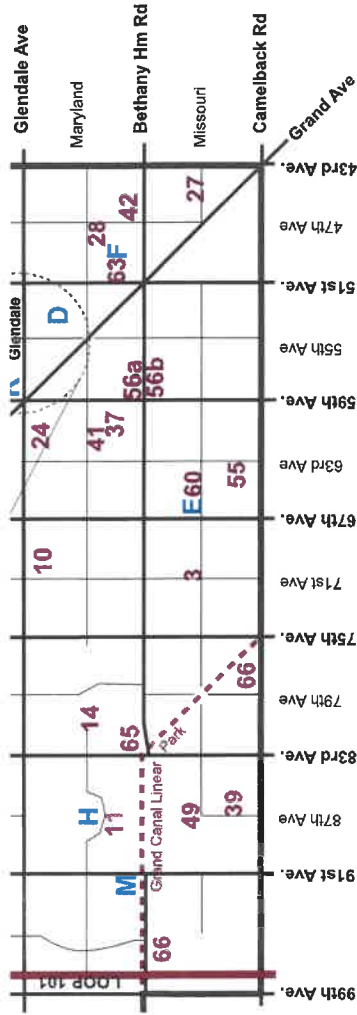

Parks	Acres & Amenities	Parks	Acres & Amenities	Parks	Acres & Amenities
1 Acoma	3.3	28 Maryland Lakes	6.0	55 Windor	1.0
2 Arrowhead Lakes	5.0	29 Memmingen	3.0	56a Bonsall (north)	10.0
3 Bicentennial	5.0	30 Mission	4.5	56b Bonsall (south)	7.0
4 Butler	5.0	31 Mondo	5.2	57 Chapparal	12.0
5 Carmel	5.0	32 Montara	5.3	58 Hidden Meadows	10.0
6 Cholla	5.7	33 Murphy	2.5	59 Northern Horizon	40.0
7 Clavelito	5.0	34 Myrtle	1.0	60 O'Neil Park	11.0
8 Country Gables	4.0	35 New World	8.0	61 Orangewood	5.0
9 Delicias	5.0	36 Oasis	5.6	62 Paseo Racquet Center	23.0
10 Desert Garden	6.6	37 Ocotillo Rose	2.2	63 Rose Lane	19.0
11 Desert Mirage	7.4	38 Orangewood Vista	10.0	64 Foothills	40.0
12 Desert Rose	7.0	39 Pasadena	3.0	65 Glendale Heroes	81.0
13 Desert Valley	6.0	40 Paseo Neighborhood	3.0	66 Grand Canal Linear	24.3
14 Discovery	9.1	41 Plaza Rosa	0.2	67 Sahuaro Ranch	80.0
15 Dos Lagos	5.7	42 Rovey	0.4	68 Skunk Creek Linear	70.0
16 El Barrio	0.4	43 Sands	5.6	69 Thunderbird Paseo	55.0
17 Gardenwood	1.5	44 Sierra Verde	8.0	70 Thunderbird	1185
18 Greenbriar	3.0	45 Sonorita	1.0		
19 Greenway Granada	6.7	46 Sunnyside	8.0		
20 Heritage	3.3	47 Sunset	3.6		
21 Hillcrest	8.0	48 Sunset Palms	8.0		
22 Horizon	5.0	49 Sunset Ridge	10.0		
23 Kings	5.0	50 Sunset Vista	5.0		
24 Lawrence	2.9	51 Sycamore Grove	5.0		
25 Lions	4.2	52 Tarrington Ranch	5.0		
26 Manistee Ranch	4.3	53 Tierra Buena	5.0		
27 Mary Silva	5.0	54 Utopia	3.0		

**Legend**

- Ballfield
- Basketball
- Racquetball
- Soccer/football field
- Tennis
- Volleyball
- Playground
- Picnic Tables
- Grills
- Indicates Number of Ramadas
- Dog Park
- Splash Pad
- Trails
- Restrooms

• Lighted sports facilities:  
• If more than one field or court, number is on icon