



CITY OF GLENDALE, ARIZONA

**DEVELOPMENT IMPACT FEE
UNAUDITED**

STATEMENT OF REVENUES, EXPENDITURES AND CHANGES IN FUND BALANCE
As of June 30, 2019

ACCOUNTING FOR THE COLLECTION AND USE OF DEVELOPMENT IMPACT FEES
ANNUAL REPORT

Table of Contents

Development Impact Fee Schedule	1
Unaudited Statement of Revenue, Expenditures, and Change in Fund Balance	
Development Impact Fee Account Summary – Government Funds	3
Detailed Development Impact Fee Expenditure Report – Government Funds	6
Development Impact Fee Account Summary – Enterprise Funds	11
Detailed Development Impact Fee Expenditure Report – Enterprise Funds	12
City of Glendale Map	Appendix A

TABLE 1: SCHEDULE OF COMMUNITY DEVELOPMENT IMPACT FEES

NON-UTILITY FEES FOR RESIDENTIAL DEVELOPMENT					
Residential - per Dwelling Unit in East Glendale					
Type	Parks and Recreation	Streets	Police	Fire	Total
Single Unit	\$909	\$1,551	\$339	\$1,146	\$3,945
2+ Units per Structure	\$517	\$865	\$193	\$652	\$2,227
Residential - per Dwelling Unit in West 101 Glendale					
Type	Parks and Recreation	Streets	Police	Fire	Total
Single Unit	\$909	\$3,522	\$339	\$1,146	\$5,916
2+ Units per Structure	\$517	\$1,963	\$193	\$652	\$3,325
NON-UTILITY FEES FOR NON-RESIDENTIAL DEVELOPMENT					
Non-Residential - per Thousand Square Feet of Floor Area in East Glendale					
Type	Parks and Recreation	Streets	Police	Fire	Total
Industrial	\$23	\$308	\$12	\$129	\$472
Commercial	\$43	\$2,210	\$99	\$239	\$2,591
Institutional	\$30	\$883	\$36	\$166	\$1,115
Office & Other Services	\$101	\$957	\$39	\$563	\$1,660
Non-Residential - per Thousand Square Feet of Floor Area in West 101 Glendale					
Type	Parks and Recreation	Streets	Police	Fire	Total
Industrial	\$23	\$701	\$12	\$129	\$865
Commercial	\$43	\$5,017	\$99	\$239	\$5,398
Institutional	\$30	\$2,005	\$36	\$166	\$2,237
Office & Other Services	\$101	\$2,172	\$39	\$563	\$2,875
Non-Residential - per Thousand Square Feet of Floor Area in West 303 Glendale					
Type	Parks and Recreation	Streets	Police	Fire	Total
Industrial	\$0	\$1,154	\$12	\$129	\$1,295
Commercial	\$0	\$8,260	\$99	\$239	\$8,598
Institutional	\$0	\$3,301	\$36	\$166	\$3,503
Office & Other Services	\$0	\$3,575	\$39	\$563	\$4,177

TABLE 1: SCHEDULE OF COMMUNITY DEVELOPMENT IMPACT FEES
(Continued)

Utility Fees for all Development Types (per meter) in East Glendale and West 101 Glendale			
Meter Size	Water	Wastewater	Total
0.75	\$2,761	\$1,944	\$4,705
1.00	\$4,607	\$3,243	\$7,850
1.50	\$9,183	\$6,462	\$15,645
2.00	\$14,695	\$10,341	\$25,036
3.00	\$29,413	\$20,696	\$50,109
4.00	\$45,950	\$32,331	\$78,281
6.00	\$91,867	\$64,637	\$156,504
8.00	\$146,991	\$103,420	\$250,411

MAP OF SERVICE ZONES FOR CITY OF GLENDALE

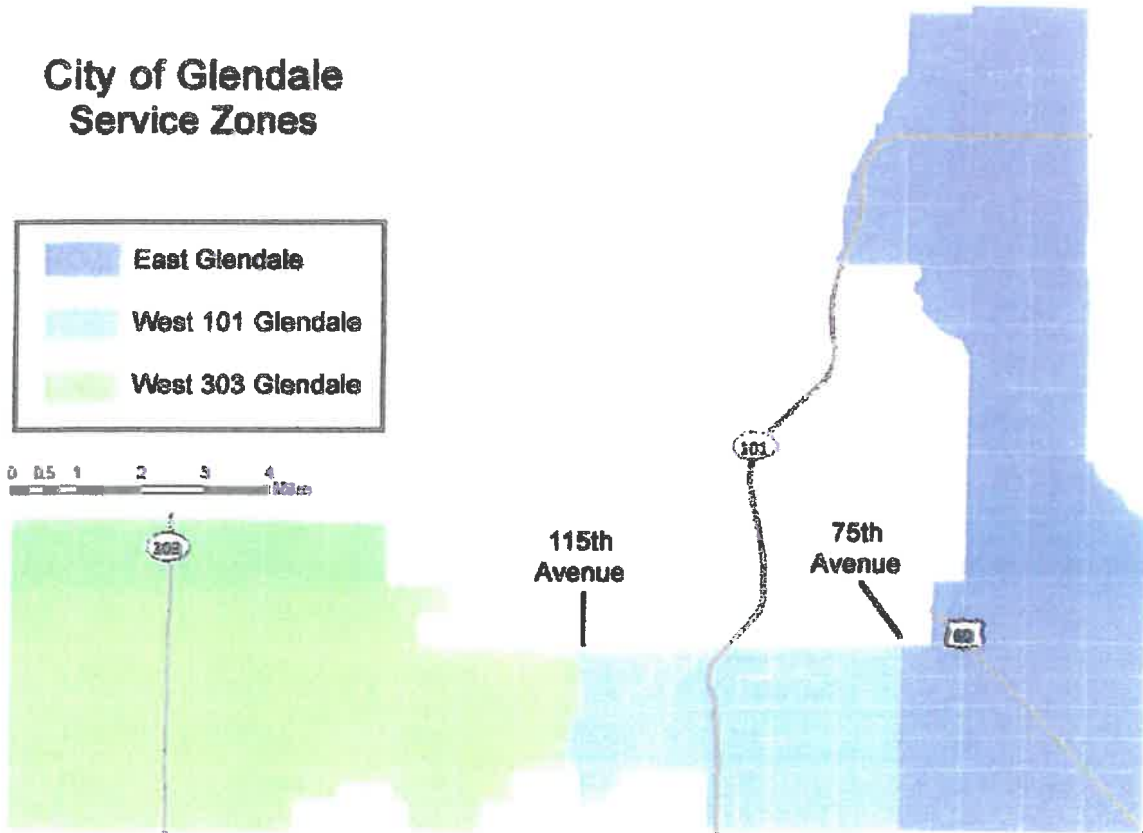

Prepared for Glendale, Arizona by TischlerBlise

City of Glendale
 Development Impact Fee Report
 Unaudited - Statement of Revenue, Expenditures, and Change in Fund Balances
 For Fiscal Year Ending June 30, 2019

Development Impact Fee Account Summary - Government Funds

	Fund 4120	Fund 4130	Fund 4180	Fund 4230	Fund 4250	Fund 4270	Fund 4290	Fund 4300	Fund 4350	Fund 4370	Fund 4390	Fund 4440	Total
	Library Buildings	Fire Prot. Facilities	Police Facilities	Parks-Citywide Parks	Parks-Citywide Recreation Areas	Library DIF	Parks-Citywide Open Space & Trails	Parks-Zone 1	Parks-Zone 2	Parks Zone 3	Roadway Improvements	General Government	
FY18 Annual Report Ending Balance	\$ 1,802,608.67	\$ 0.00	\$ 6,078.67	\$ 232,108.17	\$ 506,815.78	\$ 1,337,484.09	\$ 516,684.69	\$ 127,450.38	\$ 169,920.18	\$ 495.39	\$ 180,930.34	\$ 145,640.88	\$ 5,026,217.24
Revenue Adjustment	-	-	-	-	-	-	-	-	-	-	-	-	-
Expenditure Adjustment	-	-	-	-	-	-	-	-	-	-	-	-	-
Beginning Balance at July 1, 2018	\$ 1,802,608.67	\$ 0.00	\$ 6,078.67	\$ 232,108.17	\$ 506,815.78	\$ 1,337,484.09	\$ 516,684.69	\$ 127,450.38	\$ 169,920.18	\$ 495.39	\$ 180,930.34	\$ 145,640.88	\$ 5,026,217.24

Revenues

Total Amount of Impact Fees Collected	\$ -	\$ -	\$ -	\$ -	\$ -	\$ -	\$ -	\$ -	\$ -	\$ -	\$ -	\$ -	\$ -
Other Earnings	\$ -	\$ -	\$ -	\$ -	\$ -	\$ -	\$ -	\$ -	\$ -	\$ -	\$ -	\$ -	\$ -
Interest Earned on Each Account	\$ 12,547.00	\$ -	\$ 115.00	\$ 1,055.00	\$ 2,938.00	\$ 15,393.00	\$ 6,350.00	\$ 1,434.00	\$ 3,227.00	\$ 94.00	\$ 2,952.00	\$ 2,916.00	\$ 49,021.00
Total Revenues	\$ 12,547.00	\$ -	\$ 115.00	\$ 1,055.00	\$ 2,938.00	\$ 15,393.00	\$ 6,350.00	\$ 1,434.00	\$ 3,227.00	\$ 94.00	\$ 2,952.00	\$ 2,916.00	\$ 49,021.00

Expenditures

	Fund 4120	Fund 4130	Fund 4180	Fund 4230	Fund 4250	Fund 4270	Fund 4290	Fund 4300	Fund 4350	Fund 4370	Fund 4390	Fund 4440	Total
	Library Buildings	Fire Prot. Facilities	Police Facilities	Parks-Citywide Parks	Parks-Citywide Recreation Areas	Library DIF	Parks-Citywide Open Space & Trails	Parks-Zone 1	Parks-Zone 2	Parks Zone 3	Roadway Improvements	General Government	
Total Capital Project Expenditures	\$ 1,815,155.67	\$ -	\$ -	\$ 229,369.83	\$ 473,213.96	\$ 1,092,820.75	\$ 261,609.15	\$ 65,043.03	\$ -	\$ -	\$ -	\$ -	\$ 3,937,212.39
Bonds	\$ -	\$ -	\$ -	\$ -	\$ -	\$ -	\$ -	\$ -	\$ -	\$ -	\$ -	\$ -	\$ -
Principal	\$ -	\$ -	\$ -	\$ -	\$ -	\$ -	\$ -	\$ -	\$ -	\$ -	\$ -	\$ -	\$ -
Interest	\$ -	\$ -	\$ -	\$ -	\$ -	\$ -	\$ -	\$ -	\$ -	\$ -	\$ -	\$ -	\$ -
Debt Service on Bonds (Total Paid)	\$ -	\$ -	\$ -	\$ -	\$ -	\$ -	\$ -	\$ -	\$ -	\$ -	\$ -	\$ -	\$ -
Capital Leases	\$ -	\$ -	\$ -	\$ -	\$ -	\$ -	\$ -	\$ -	\$ -	\$ -	\$ -	\$ -	\$ -
Principal	\$ -	\$ -	\$ -	\$ -	\$ -	\$ -	\$ -	\$ -	\$ -	\$ -	\$ -	\$ -	\$ -
Interest	\$ -	\$ -	\$ -	\$ -	\$ -	\$ -	\$ -	\$ -	\$ -	\$ -	\$ -	\$ -	\$ -
Payment on Capital Leases (Total Paid)	\$ -	\$ -	\$ -	\$ -	\$ -	\$ -	\$ -	\$ -	\$ -	\$ -	\$ -	\$ -	\$ -
Other Expenditures	\$ -	\$ -	\$ -	\$ -	\$ 19,949.32	\$ 260,056.34	\$ -	\$ 10,267.30	\$ -	\$ 589.39	\$ 36,046.07	\$ -	\$ 326,908.42
Advances from Other Funds	\$ -	\$ -	\$ -	\$ -	\$ -	\$ -	\$ -	\$ -	\$ -	\$ -	\$ -	\$ -	\$ -
Total Expenditures	\$ 1,815,155.67	\$ -	\$ -	\$ 229,369.83	\$ 493,163.28	\$ 1,352,877.09	\$ 261,609.15	\$ 75,310.33	\$ -	\$ 589.39	\$ 36,046.07	\$ -	\$ 4,254,120.83

FY19 End of Year Balance

Beginning Balance	\$ 1,802,608.67	\$ 0.00	\$ 6,078.67	\$ 232,108.17	\$ 506,815.78	\$ 1,337,484.09	\$ 516,684.69	\$ 127,450.38	\$ 169,920.18	\$ 495.39	\$ 180,930.34	\$ 145,640.88	\$ 5,026,217.24
Total Revenues	\$ 12,547.00	\$ -	\$ 115.00	\$ 1,055.00	\$ 2,938.00	\$ 15,393.00	\$ 6,350.00	\$ 1,434.00	\$ 3,227.00	\$ 94.00	\$ 2,952.00	\$ 2,916.00	\$ 49,021.00
Total Expenditures	\$ 1,815,155.67	\$ -	\$ -	\$ 229,369.83	\$ 493,163.28	\$ 1,352,877.09	\$ 261,609.15	\$ 75,310.33	\$ -	\$ 589.39	\$ 36,046.07	\$ -	\$ 4,254,120.81
Ending Balance as of June 30, 2019	\$ -	\$ 0.00	\$ 6,193.67	\$ 3,793.34	\$ 16,590.50	\$ -	\$ 261,425.54	\$ 52,141.05	\$ 173,147.18	\$ 0.00	\$ 47,836.27	\$ 148,556.88	\$ 5,117,117.43

City of Glendale
 Development Impact Fee Report
 Unaudited - Statement of Revenue, Expenditures, and Change in Fund Balances
 For Fiscal Year Ending June 30, 2019

Development Impact Fee Account Summary - Government Funds

	Fund 4140	Fund 4190	Fund 4240	Fund 4260	Fund 4280	Fund 4310	Fund 4360	Fund 4380	Fund 4400	Total
	Fire Protection Facilities	Police Facilities	Citywide Parks Recreation Fac	Citywide Recreation Fac	Libraries	Parks Dev Zone 1	Parks Dev Zone 2	Parks Dev Zone 3	Roadway Improvements	
FY18 Annual Report Ending Balance	\$ -	\$ 422,606.59	\$ 108,524.43	\$ 108,524.43	\$ 207,676.08	\$ 53,720.37	\$ 13,183.13	\$ 13,884.47	\$ 1,356,109.40	\$ 2,284,228.90
Revenue Adjustment	\$ -	\$ -	\$ -	\$ -	\$ -	\$ -	\$ -	\$ -	\$ -	\$ -
Expenditure Adjustment	\$ -	\$ -	\$ -	\$ -	\$ -	\$ -	\$ -	\$ -	\$ -	\$ -
Beginning Balance at July 1, 2018	\$ -	\$ 422,606.59	\$ 108,524.43	\$ 108,524.43	\$ 207,676.08	\$ 53,720.37	\$ 13,183.13	\$ 13,884.47	\$ 1,356,109.40	\$ 2,284,228.90

Revenues

Total Amount of Impact Fees Collected	\$ -	\$ -	\$ -	\$ -	\$ -	\$ -	\$ -	\$ -	\$ -	\$ -
Other Earnings	\$ -	\$ -	\$ -	\$ -	\$ -	\$ -	\$ -	\$ -	\$ -	\$ -
Interest Earned on Each Account	\$ -	\$ 8,025.00	\$ 2,026.00	\$ 2,060.00	\$ 3,945.00	\$ 1,019.00	\$ 248.00	\$ 263.00	\$ 15,654.00	\$ 33,240.00
Total Revenues	\$ -	\$ 8,025.00	\$ 2,026.00	\$ 2,060.00	\$ 3,945.00	\$ 1,019.00	\$ 248.00	\$ 263.00	\$ 15,654.00	\$ 33,240.00

Expenditures

	Fund 4140	Fund 4190	Fund 4240	Fund 4260	Fund 4280	Fund 4310	Fund 4360	Fund 4380	Fund 4400	Total
	Fire Protection Facilities	Police Facilities	Citywide Parks Recreation Fac	Citywide Recreation Fac	Libraries	Parks Dev Zone 1	Parks Dev Zone 2	Parks Dev Zone 3	Roadway Improvements	
Total Capital Project Expenditures	\$ -	\$ -	\$ 2,040.00	\$ -	\$ 164,691.29	\$ -	\$ -	\$ -	\$ 1,071,416.74	\$ 1,238,148.03
Bonds	\$ -	\$ -	\$ -	\$ -	\$ -	\$ -	\$ -	\$ -	\$ -	\$ -
Principal	\$ -	\$ -	\$ -	\$ -	\$ -	\$ -	\$ -	\$ -	\$ -	\$ -
Interest	\$ -	\$ -	\$ -	\$ -	\$ -	\$ -	\$ -	\$ -	\$ -	\$ -
Debt Service on Bonds (Total Paid)	\$ -	\$ -	\$ -	\$ -	\$ -	\$ -	\$ -	\$ -	\$ -	\$ -
Capital Leases	\$ -	\$ -	\$ -	\$ -	\$ -	\$ -	\$ -	\$ -	\$ -	\$ -
Principal	\$ -	\$ -	\$ -	\$ -	\$ -	\$ -	\$ -	\$ -	\$ -	\$ -
Interest	\$ -	\$ -	\$ -	\$ -	\$ -	\$ -	\$ -	\$ -	\$ -	\$ -
Payment on Capital Leases (Total Paid)	\$ -	\$ -	\$ -	\$ -	\$ -	\$ -	\$ -	\$ -	\$ -	\$ -
Other Expenditures	\$ -	\$ -	\$ -	\$ -	\$ -	\$ -	\$ -	\$ -	\$ -	\$ -
Advances from Other Funds	\$ -	\$ -	\$ -	\$ -	\$ -	\$ -	\$ -	\$ -	\$ -	\$ -
Total Expenditures	\$ -	\$ -	\$ 2,040.00	\$ -	\$ 164,691.29	\$ -	\$ -	\$ -	\$ 1,071,416.74	\$ 1,238,148.03

FY19 End of Year Balance

	Fund 4140	Fund 4190	Fund 4240	Fund 4260	Fund 4280	Fund 4310	Fund 4360	Fund 4380	Fund 4400	Total
	Fire Protection Facilities	Police Facilities	Citywide Parks Recreation Fac	Citywide Recreation Fac	Libraries	Parks Dev Zone 1	Parks Dev Zone 2	Parks Dev Zone 3	Roadway Improvements	
Beginning Balance	\$ -	\$ 422,606.59	\$ 108,524.43	\$ 108,524.43	\$ 207,676.08	\$ 53,720.37	\$ 13,183.13	\$ 13,884.47	\$ 1,356,109.40	\$ 2,284,228.90
Total Revenues	\$ -	\$ 8,025.00	\$ 2,026.00	\$ 2,060.00	\$ 3,945.00	\$ 1,019.00	\$ 248.00	\$ 263.00	\$ 15,654.00	\$ 33,240.00
Total Expenditures	\$ -	\$ -	\$ 2,040.00	\$ -	\$ 164,691.29	\$ -	\$ -	\$ -	\$ 1,071,416.74	\$ 1,238,148.03
Ending Balance as of June 30, 2019	\$ -	\$ 430,631.59	\$ 108,510.43	\$ 110,584.43	\$ 46,929.79	\$ 54,739.37	\$ 13,431.13	\$ 14,147.47	\$ 300,345.66	\$ 1,079,320.87

City of Glendale
 Development Impact Fee Report
 Unaudited - Statement of Revenue, Expenditures, and Change in Fund Balances
 For Fiscal Year Ending June 30, 2019

Development Impact Fee Account Summary - Government Funds

	Fund 4150	Fund 4160	Fund 4170	Fund 4200	Fund 4210	Fund 4220	Fund 4320	Fund 4330	Fund 4340	Fund 4410	Fund 4420	Fund 4430	Fund 4430	Total
	DIF-Fire Zone 1 East	DIF-Fire Zone 2 West 101	DIF-Fire Zone 3 West 303	DIF-Police Zone 1 East	DIF-Police Zone 2 West 101	DIF-Police Zone 3 West 303	DIF-Parks & Rec Zone 1 East	DIF-Parks & Rec Zone 2 West 101	DIF-Parks & Rec Zone 3 West 303	DIF-Streets Zone 1 East	DIF-Streets Zone 2 West 101	DIF-Streets Zone 3 West 303	DIF-Streets Zone 3 West 303	
FY18 Annual Report Ending Balance	\$ 840,190.91	\$ 1,010,065.90	\$ 4,841.58	\$ 205,323.45	\$ 221,771.07	\$ 446.87	\$ 432,814.32	\$ 568,524.07	\$ -	\$ 1,420,077.95	\$ 3,850,164.54	\$ 43,242.14	\$ 43,242.14	\$ 6,597,462.80
Revenue Adjustment	\$ -	\$ -	\$ -	\$ -	\$ -	\$ -	\$ -	\$ -	\$ -	\$ -	\$ -	\$ -	\$ -	\$ -
Expenditure Adjustment	\$ -	\$ -	\$ -	\$ -	\$ -	\$ -	\$ -	\$ -	\$ -	\$ -	\$ -	\$ -	\$ -	\$ -
Beginning Balance at July 1, 2018	\$ 840,190.91	\$ 1,010,065.90	\$ 4,841.58	\$ 205,323.45	\$ 221,771.07	\$ 446.87	\$ 432,814.32	\$ 568,524.07	\$ -	\$ 1,420,077.95	\$ 3,850,164.54	\$ 43,242.14	\$ 43,242.14	\$ 6,597,462.80

Revenues

Total Amount of Impact Fees Collected	\$ 482,455.41	\$ 273,039.49	\$ -	\$ 124,592.65	\$ 68,504.91	\$ -	\$ 328,645.27	\$ 180,149.08	\$ -	\$ 828,285.45	\$ 938,381.93	\$ -	\$ -	\$ 3,224,054.19
Other Earnings	\$ -	\$ -	\$ -	\$ -	\$ -	\$ -	\$ -	\$ -	\$ -	\$ -	\$ -	\$ -	\$ -	\$ -
Interest Earned on Each Account	\$ 20,562.00	\$ 21,642.00	\$ 92.00	\$ 5,000.00	\$ 4,872.00	\$ -	\$ 11,080.00	\$ 8,744.00	\$ -	\$ 35,415.00	\$ 80,252.00	\$ 821.00	\$ 821.00	\$ 188,480.00
Total Revenues	\$ 503,017.41	\$ 294,681.49	\$ 92.00	\$ 129,592.65	\$ 73,376.91	\$ -	\$ 339,725.27	\$ 188,893.08	\$ -	\$ 863,700.45	\$ 1,018,633.93	\$ 821.00	\$ 821.00	\$ 3,412,534.19

Expenditures

	Fund 4150	Fund 4160	Fund 4170	Fund 4200	Fund 4210	Fund 4220	Fund 4320	Fund 4330	Fund 4340	Fund 4410	Fund 4420	Fund 4430	Total
	DIF-Fire Zone 1 East	DIF-Fire Zone 2 West 101	DIF-Fire Zone 3 West 303	DIF-Police Zone 1 East	DIF-Police Zone 2 West 101	DIF-Police Zone 3 West 303	DIF-Parks & Rec Zone 1 East	DIF-Parks & Rec Zone 2 West 101	DIF-Parks & Rec Zone 3 West 303	DIF-Streets Zone 1 East	DIF-Streets Zone 2 West 101	DIF-Streets Zone 3 West 303	
Total Capital Project Expenditures	\$ -	\$ -	\$ -	\$ -	\$ -	\$ -	\$ 5,000.00	\$ 284,769.76	\$ -	\$ -	\$ 181,925.43	\$ -	\$ 471,695.19
Bonds	\$ -	\$ -	\$ -	\$ -	\$ -	\$ -	\$ -	\$ -	\$ -	\$ -	\$ -	\$ -	\$ -
Principal	\$ -	\$ -	\$ -	\$ -	\$ -	\$ -	\$ -	\$ -	\$ -	\$ -	\$ -	\$ -	\$ -
Interest	\$ -	\$ -	\$ -	\$ -	\$ -	\$ -	\$ -	\$ -	\$ -	\$ -	\$ -	\$ -	\$ -
Debt Service on Bonds (Total Paid)	\$ -	\$ -	\$ -	\$ -	\$ -	\$ -	\$ -	\$ -	\$ -	\$ -	\$ -	\$ -	\$ -
Capital Leases	\$ -	\$ -	\$ -	\$ -	\$ -	\$ -	\$ -	\$ -	\$ -	\$ -	\$ -	\$ -	\$ -
Principal	\$ -	\$ -	\$ -	\$ -	\$ -	\$ -	\$ -	\$ -	\$ -	\$ -	\$ -	\$ -	\$ -
Interest	\$ -	\$ -	\$ -	\$ -	\$ -	\$ -	\$ -	\$ -	\$ -	\$ -	\$ -	\$ -	\$ -
Payment on Capital Leases (Total Paid)	\$ -	\$ -	\$ -	\$ -	\$ -	\$ -	\$ -	\$ -	\$ -	\$ -	\$ -	\$ -	\$ -
Other Expenditures	\$ -	\$ -	\$ -	\$ -	\$ -	\$ -	\$ -	\$ -	\$ -	\$ -	\$ -	\$ -	\$ -
Advances from Other Funds	\$ -	\$ -	\$ -	\$ -	\$ -	\$ -	\$ -	\$ -	\$ -	\$ -	\$ -	\$ -	\$ -
Total Expenditures	\$ -	\$ -	\$ -	\$ -	\$ -	\$ -	\$ 5,000.00	\$ 284,769.76	\$ -	\$ -	\$ 181,925.43	\$ -	\$ 471,695.19

FY19 End of Year Balance

Beginning Balance	\$ 840,190.91	\$ 1,010,065.90	\$ 4,841.58	\$ 205,323.45	\$ 221,771.07	\$ 446.87	\$ 432,814.32	\$ 568,524.07	\$ -	\$ 1,420,077.95	\$ 3,850,164.54	\$ 43,242.14	\$ 43,242.14	\$ 8,597,462.80
Total Revenues	\$ 503,017.41	\$ 294,681.49	\$ 92.00	\$ 129,592.65	\$ 73,376.91	\$ -	\$ 339,725.27	\$ 188,893.08	\$ -	\$ 863,700.45	\$ 1,018,633.93	\$ 821.00	\$ 821.00	\$ 3,412,534.19
Total Expenditures	\$ -	\$ -	\$ -	\$ -	\$ -	\$ -	\$ 5,000.00	\$ 284,769.76	\$ -	\$ -	\$ 181,925.43	\$ -	\$ -	\$ 471,695.19
Ending Balance as of June 30, 2019	\$ 1,343,208.32	\$ 1,304,747.39	\$ 4,933.58	\$ 334,916.10	\$ 295,147.98	\$ 446.87	\$ 767,539.59	\$ 477,647.39	\$ -	\$ 2,283,778.40	\$ 4,868,873.04	\$ 44,063.14	\$ 44,063.14	\$ 11,538,304.80

City of Glendale
 Development Impact Fee Report
 Unaudited - Statement of Revenue, Expenditures, and Change in Fund Balances
 For Fiscal Year Ending June 30, 2019

Detailed Development Impact Fee Expenditure Report - Government Funds

Fund 4120

Library Buildings

Location	Capital Projects	Bonds	Capital Lease	Other	Total
83rd Avenue and Bethany Home Road, Glendale AZ	\$ 1,815,155.67	\$ -	\$ -	\$ -	\$ 1,815,155.67
Total Expenditures	\$ 1,815,155.67	\$ -	\$ -	\$ -	\$ 1,815,155.67

Fund 4230

Parks-Citywide Parks

Location	Capital Projects	Bonds	Capital Lease	Other	Total
83rd Avenue and Bethany Home Road, Glendale AZ	\$ 4,360.00	\$ -	\$ -	\$ -	\$ 4,360.00
78th Ave & Orangewood Ave, Glendale AZ	\$ 225,009.83				\$ 225,009.83
Total Expenditures	\$ 229,369.83	\$ -	\$ -	\$ -	\$ 229,369.83

Fund 4240

Citywide Parks

Location	Capital Projects	Bonds	Capital Lease	Other	Total
83rd Avenue and Bethany Home Road, Glendale AZ	\$ 2,040.00	\$ -	\$ -	\$ -	\$ 2,040.00
	\$ -				\$ -
Total Expenditures	\$ 2,040.00	\$ -	\$ -	\$ -	\$ 2,040.00

City of Glendale
 Development Impact Fee Report
 Unaudited - Statement of Revenue, Expenditures, and Change in Fund Balances
 For Fiscal Year Ending June 30, 2019

Detailed Development Impact Fee Expenditure Report - Government Funds

Fund 4250

Parks-Citywide Recreation Areas

Location	Capital Projects	Bonds	Capital Lease	Other	Total
83rd Avenue and Bethany Home Road, Glendale AZ	\$ 139,838.00	-	\$ -	-	\$ 139,838.00
83rd Avenue and Bethany Home Road, Glendale AZ	\$ 333,375.96				\$ 333,375.96
City of Glendale - 5850 W Glendale Ave, Glendale AZ				\$ 19,949.32	\$ 19,949.32
					\$ -
					\$ -
Total Expenditures	\$ 473,213.96	\$ -	\$ -	\$ 19,949.32	\$ 493,163.28

Fund 4270

Library DIF

Location	Capital Projects	Bonds	Capital Lease	Other	Total
Various locations throughout the City	\$ 241,734.42	-	\$ -	-	\$ 241,734.42
83rd Avenue and Bethany Home Road, Glendale AZ	\$ 1,092,820.75				\$ 1,092,820.75
City of Glendale - 5850 W Glendale Ave, Glendale AZ				\$ 18,321.92	\$ 18,321.92
					\$ -
					\$ -
Total Expenditures	\$ 1,334,555.17	\$ -	\$ -	\$ 18,321.92	\$ 1,352,877.09

Fund 4280

Libraries

Location	Capital Projects	Bonds	Capital Lease	Other	Total
83rd Avenue and Bethany Home Road, Glendale AZ	\$ 164,691.29	-	\$ -	-	\$ 164,691.29
					\$ -
					\$ -
					\$ -
					\$ -
Total Expenditures	\$ 164,691.29	\$ -	\$ -	\$ -	\$ 164,691.29

City of Glendale
 Development Impact Fee Report
 Unaudited - Statement of Revenue, Expenditures, and Change in Fund Balances
 For Fiscal Year Ending June 30, 2019

Detailed Development Impact Fee Expenditure Report - Government Funds

Fund 4290

Parks-Citywide Open Space & Trails		Capital Projects	Bonds	Capital Lease	Other	Total
	Location					
Heroes Regional Park Library	83rd Avenue and Bethany Home Road, Glendale AZ	\$ 11,281.00	\$ -	\$ -	\$ -	\$ 11,281.00
Pasadena Park	87th Avenue and W Pasadena Ave, Glendale AZ	\$ 123,883.35				\$ 123,883.35
Discovery Park	6416 N 79th Lane, Glendale AZ	\$ 126,444.80				\$ 126,444.80
Total Expenditures		\$ 261,609.15	\$ -	\$ -	\$ -	\$ 261,609.15

Fund 4300
 Parks-Zone 1

Parks & Rec Zone 1 East		Capital Projects	Bonds	Capital Lease	Other	Total
	Location					
Orangewood Vista Park	78th Ave & Orangewood Ave, Glendale AZ	\$ 65,043.03	\$ -	\$ -	\$ -	\$ 65,043.03
Development Impact Fee Study	City of Glendale - 5850 W Glendale Ave, Glendale AZ			\$ 10,267.30		\$ 10,267.30
Total Expenditures		\$ 65,043.03	\$ -	\$ -	\$ 10,267.30	\$ 75,310.33

Fund 4320
 Parks & Rec Zone 1 East

Parks & Rec Zone 1 East		Capital Projects	Bonds	Capital Lease	Other	Total
	Location					
Bike Park-Foothill Park	57th Ave and Union Hills Rd., Glendale AZ	\$ 5,000.00	\$ -	\$ -	\$ -	\$ 5,000.00
Total Expenditures		\$ 5,000.00	\$ -	\$ -	\$ -	\$ 5,000.00

City of Glendale
 Development Impact Fee Report
 Unaudited - Statement of Revenue, Expenditures, and Change in Fund Balances
 For Fiscal Year Ending June 30, 2019

Detailed Development Impact Fee Expenditure Report - Government Funds

Fund 4400		Location		Capital Projects	Bonds	Capital Lease	Other	Total
Roadway Improvements								
Traffic Intersection Improvements	95th Ave & Camelback Rd, Glendale AZ	\$	442,604.00	\$	-	\$	-	\$ 442,604.00
Traffic Intersection Improvements	59th Ave & Olive, Glendale AZ	\$	628,812.74					\$ 628,812.74
								\$ -
								\$ -
								\$ -
Total Expenditures		\$	1,071,416.74	\$	-	\$	-	\$ 1,071,416.74

Fund 4420		Location		Capital Projects	Bonds	Capital Lease	Other	Total
Streets Zone 2 West 101								
Street Improvements	83rd thru 91st Ave & Bethany Home Rd, Glendale AZ	\$	181,925.43	\$	-	\$	-	\$ 181,925.43
								\$ -
								\$ -
								\$ -
Total Expenditures		\$	181,925.43	\$	-	\$	-	\$ 181,925.43

City of Glendale
 Development Impact Fee Report
 Unaudited - Statement of Revenue, Expenditures, and Change in Fund Balances
 For Fiscal Year Ending June 30, 2019

Development Impact Fee Account Summary - Enterprise Funds

	Fund 6050		Fund 6060		Fund 6070		Fund 6080		Fund 6090		Fund 6100		Total
	Water DIF Zone 1 East	Water DIF Zone 2 West 101	Water DIF Zone 2 West 101	Water DIF Zone 3 West 303	Sewer DIF Zone 1 East	Sewer DIF Zone 2 West 101	Sewer DIF Zone 3 West 303	Sewer DIF Zone 1 East	Sewer DIF Zone 2 West 101	Sewer DIF Zone 3 West 303	Sewer DIF Zone 3 West 303		
FY18 Annual Report Ending Balance	\$ 1,528,619.23	\$ 1,678,195.29	\$ -	\$ -	\$ 873,488.21	\$ 1,042,737.46	\$ -	\$ -	\$ -	\$ -	\$ -	\$ -	\$ 5,123,040.19
Revenue Adjustment	\$ -	\$ -	\$ -	\$ -	\$ -	\$ -	\$ -	\$ -	\$ -	\$ -	\$ -	\$ -	\$ -
Expenditure Adjustment	\$ -	\$ -	\$ -	\$ -	\$ -	\$ -	\$ -	\$ -	\$ -	\$ -	\$ -	\$ -	\$ -
Beginning Balance at July 1, 2018	\$ 1,528,619.23	\$ 1,678,195.29	\$ -	\$ -	\$ 873,488.21	\$ 1,042,737.46	\$ -	\$ -	\$ -	\$ -	\$ -	\$ -	\$ 5,123,040.19

Revenues

Total Amount of Impact Fees Collected	\$ 863,592.00	\$ 346,603.00	\$ -	\$ -	\$ 533,965.00	\$ 212,268.00	\$ -	\$ -	\$ -	\$ -	\$ -	\$ -	\$ 1,956,428.00
Other Earnings	\$ -	\$ -	\$ -	\$ -	\$ -	\$ -	\$ -	\$ -	\$ -	\$ -	\$ -	\$ -	\$ -
Interest Earned on Each Account	\$ 38,463.00	\$ 34,805.00	\$ -	\$ -	\$ 22,278.00	\$ 21,549.00	\$ -	\$ -	\$ -	\$ -	\$ -	\$ -	\$ 117,095.00
Total Revenues	\$ 902,055.00	\$ 381,408.00	\$ -	\$ -	\$ 556,243.00	\$ 233,817.00	\$ -	\$ -	\$ -	\$ -	\$ -	\$ -	\$ 2,073,523.00

Expenditures

	Fund 6050		Fund 6060		Fund 6070		Fund 6080		Fund 6090		Fund 6100		Total
	Water DIF Zone 1 East	Water DIF Zone 2 West 101	Water DIF Zone 2 West 101	Water DIF Zone 3 West 303	Sewer DIF Zone 1 East	Sewer DIF Zone 2 West 101	Sewer DIF Zone 3 West 303	Sewer DIF Zone 1 East	Sewer DIF Zone 2 West 101	Sewer DIF Zone 3 West 303	Sewer DIF Zone 3 West 303		
Total Capital Project Expenditures	\$ -	\$ -	\$ -	\$ -	\$ -	\$ -	\$ -	\$ -	\$ -	\$ -	\$ -	\$ -	\$ -
Bonds	\$ -	\$ -	\$ -	\$ -	\$ -	\$ -	\$ -	\$ -	\$ -	\$ -	\$ -	\$ -	\$ -
Principal	\$ -	\$ -	\$ -	\$ -	\$ -	\$ -	\$ -	\$ -	\$ -	\$ -	\$ -	\$ -	\$ -
Interest	\$ -	\$ -	\$ -	\$ -	\$ -	\$ -	\$ -	\$ -	\$ -	\$ -	\$ -	\$ -	\$ -
Debt Service on Bonds (Total Paid)	\$ -	\$ -	\$ -	\$ -	\$ -	\$ -	\$ -	\$ -	\$ -	\$ -	\$ -	\$ -	\$ -
Capital Lease	\$ -	\$ -	\$ -	\$ -	\$ -	\$ -	\$ -	\$ -	\$ -	\$ -	\$ -	\$ -	\$ -
Principal	\$ -	\$ -	\$ -	\$ -	\$ -	\$ -	\$ -	\$ -	\$ -	\$ -	\$ -	\$ -	\$ -
Interest	\$ -	\$ -	\$ -	\$ -	\$ -	\$ -	\$ -	\$ -	\$ -	\$ -	\$ -	\$ -	\$ -
Payment on Capital Lease (Total Paid)	\$ -	\$ -	\$ -	\$ -	\$ -	\$ -	\$ -	\$ -	\$ -	\$ -	\$ -	\$ -	\$ -
Other Expenditures	\$ -	\$ -	\$ -	\$ -	\$ -	\$ -	\$ -	\$ -	\$ -	\$ -	\$ -	\$ -	\$ -
Advances from Other Funds	\$ -	\$ -	\$ -	\$ -	\$ -	\$ -	\$ -	\$ -	\$ -	\$ -	\$ -	\$ -	\$ -
Total Expenditures	\$ -	\$ -	\$ -	\$ -	\$ -	\$ -	\$ -	\$ -	\$ -	\$ -	\$ -	\$ -	\$ -

FY19 End of Year Balance

	Fund 6050		Fund 6060		Fund 6070		Fund 6080		Fund 6090		Fund 6100		Total
	Water DIF Zone 1 East	Water DIF Zone 2 West 101	Water DIF Zone 2 West 101	Water DIF Zone 3 West 303	Sewer DIF Zone 1 East	Sewer DIF Zone 2 West 101	Sewer DIF Zone 3 West 303	Sewer DIF Zone 1 East	Sewer DIF Zone 2 West 101	Sewer DIF Zone 3 West 303	Sewer DIF Zone 3 West 303		
Total Beginning Balance	\$ 1,528,619.23	\$ 1,678,195.29	\$ -	\$ -	\$ 873,488.21	\$ 1,042,737.46	\$ -	\$ -	\$ -	\$ -	\$ -	\$ -	\$ 5,123,040.19
Total Revenues	\$ 902,055.00	\$ 381,408.00	\$ -	\$ -	\$ 556,243.00	\$ 233,817.00	\$ -	\$ -	\$ -	\$ -	\$ -	\$ -	\$ 2,073,523.00
Total Expenditures	\$ -	\$ -	\$ -	\$ -	\$ -	\$ -	\$ -	\$ -	\$ -	\$ -	\$ -	\$ -	\$ -
Ending Balance as of June 30, 2019	\$ 2,430,674.23	\$ 2,059,603.29	\$ -	\$ -	\$ 1,429,731.21	\$ 1,276,554.46	\$ -	\$ -	\$ -	\$ -	\$ -	\$ -	\$ 7,196,563.19

APPENDIX

A

Glendale Parks and Recreation Facilities

SMALL AND NEIGHBORHOOD PARKS (UP TO 10 ACRES)

- 1 Acoma Park, 53rd Ave. & Acoma Rd.
- 2 Arrowhead Lakes Park, 56th Ave. & Mohawk Ln.
- 3 Bicentennial Park, 71st Ave. & Missouri Ave.
- 4 Butler Park, 57th Ave. & Alice Ave.
- 5 Carmel Park, 52nd Dr. & Oraibi Dr.
- 6 Cholla Park, 53rd Ave. & Cholla St.
- 7 Clavelito Park, 53rd Ave. & Ocotillo Rd.
- 8 Country Gables Park, 52nd Ave. & Country Gables Dr.
- 9 Delicias Park, 48th Dr. & Orangewood Ave.
- 10 Desert Garden Park, 69th Ave. & Ocotillo Rd.
- 11 Desert Mirage Park, 87th Ave. & Maryland Ave.
- 12 Desert Rose Park, 63rd Ave. & Kings Ave.
- 13 Desert Valley Park, 61st Ave. & Sweetwater Ave.
- 14 Discovery Park, 79th Ave. & Maryland Ave.
- 15 Dos Lagos Park, 63rd Ave. & Utopia Rd.
- 16 El Barrio Park, 54th Ave. & Ocotillo Rd.
- 17 Gardenwood Park, 53rd Ave. & Orangewood Ave.
- 18 Greenbriar Park, 69th Ave. & Greenbriar Dr.
- 19 Greenway Granada Park, 73rd Ave. & Greenway Rd.
- 20 Heritage Park, 55th Ave. & Mountain View Rd.
- 21 Hillcrest Park, 71st Ave. & Hillcrest Blvd.
- 22 Horizon Park, 47th Ave. & Diana Ave.
- 23 Kings Park, 53rd Ave. & Kings Ave.
- 24 Lawrence Park, 62nd Ave. & Lawrence Rd.
- 25 Lions Park, 63rd Ave. & Haywood Ave.
- 26 Manistee Ranch Park, 52nd Ave. & Northern Ave.
- 27 Mary Silva Park, 45th Ave. & Marshall Ave.
- 28 Maryland Lakes Park, 47th Ave. & Maryland Ave.
- 29 Memmings Park, 49th Ave. & Cholla St.
- 30 Mission Park, 47th Ave. & Sunnyslope Ln.
- 31 Mondo Park, 57th Ave. & Hatcher Rd.
- 32 Montara Park, 64th Ave. & Becker Ln.
- 33 Murphy Park, 58th Ave. & Glendale Ave.
- 34 Myrtle Park, 55th Ave. & Myrtle Ave.
- 35 New World Park, 48th Dr. & Golden Ln.
- 36 Oasis Park, 79th Ave. & Utopia Rd.
- 37 Ocotillo Rose Park, 61st Ave. & Keim Rd.
- 38 Orangewood Vista Park, 79th Ave. & Orangewood Ave.
- 39 Pasadena Park, 87th Ave. & Pasadena Ave.
- 40 Paseo Neighborhood Park, 14099 N. 63rd Ave.
- 41 Plaza Rosa Park, 61st Ave. & Maryland Ave.
- 42 Rovey Park, 47th Ave. & Rovey Ave.
- 43 Sands Park, 55th Ave. & Orangewood Ave.
- 44 Sierra Verde Park, 71st Ave. & Rose Garden Ln.
- 45 Sonorita Park, 58th Dr. & Market St.
- 46 Sunnyside Park, 63rd Ave. & Cholla St.
- 47 Sunset Park, 45th Ave. & Mountain View Rd.
- 48 Sunset Palms Park, 54th Ave. & Sweetwater Ave.
- 49 Sunset Ridge Park, 87th Ave. & Missouri Ave.
- 50 Sunset Vista Park, 64th Ave. & Villa Rita Dr.
- 51 Sycamore Grove Park, 86th Ln. & Emil Rovey Pkwy.
- 52 Tarrington Ranch Park, 63rd Ave. & Butler Dr.
- 53 Tierra Buena Park, 57th Ave. & Tierra Buena Ln.
- 54 Utopia Park, 72nd Ave. & Utopia Rd.
- 55 Windsor Park, 63rd Ave. & Windsor Blvd.

REGIONAL PARKS (25 TO 200 ACRES)

- 64 Foothills Park, 57th Ave. & Union Hills Dr.
- 65 Glendale Heroes Regional Park, 83rd Ave. & Bethany Home Rd.
- 66 Grand Canal Linear Park, 75th Ave. & Camelback to Bethany Home & New River
- 67 Sahuaro Ranch Park, 59th Ave. & Mountain View Rd.
- 68 Skunk Creek Linear Park, 51st Ave. & Utopia to 73rd Ave. & Greenway
- 69 Thunderbird Paseo Park, 51st Ave. & Cactus to 72nd Ave. & Greenway

CONSERVATION PARKS (200+ ACRES)

- 70 Thunderbird Conservation Park, 59th Ave. & Pinnacle Peak Rd. (main entrance)

RECREATION CENTERS

- A Community Center North Building, 14075 N. 59th Ave.
- B Foothills Recreation & Aquatics Center, 5600 W. Union Hills Dr.
- C Glendale Adult Center, 5970 W. Brown St.
- D Glendale Community Center, 5401 W. Ocotillo Rd.
- E O'Neil Building, 6448 W. Missouri Ave.
- F Rose Lane Building, 5003 W. Marlette Ave.

POOLS

- B Foothills Recreation & Aquatics Center, 5600 W. Union Hills Dr.
- F Rose Lane Aquatics Center, 5003 W. Marlette Ave.

GOLF COURSES

- G Glen Lakes Municipal Golf Course, 5450 W. Northern Ave.
- H Desert Mirage Golf Course, 8710 W. Maryland Ave.

ADDITIONAL FACILITIES

- 64 Foothills Sk8 Court, 57th Dr. & Union Hills Dr.
- 65 X-Court, 59th Ave. & Berridge Ln.
- I Splash Pad, 59th Ave. & Berridge Ln.
- J Glendale Amphitheater, 5850 W. Glendale Ave.
- K Bridle Path, 51st Ave. from Cactus to Potter Dr.
- L Elsie McCarthy Sensory Garden, 55th Ave. & Morten Ave.
- M Paseo Racquet Center, 6268 W. Thunderbird Rd.
- N Glendale Youth Sports Complex, 6220 N. 91st Ave.

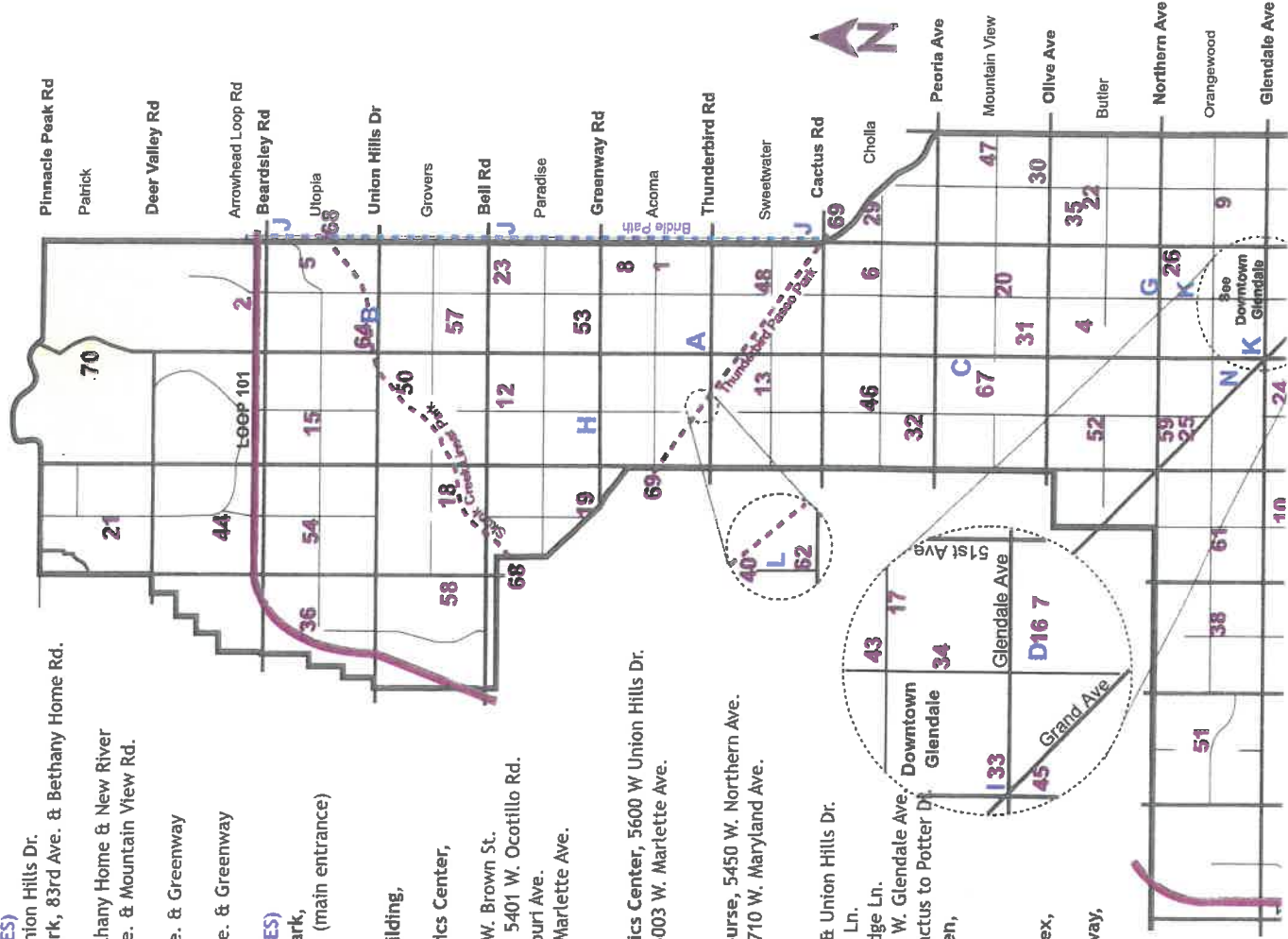

COMMUNITY PARKS (10 TO 25 ACRES)

- 56a Bonsall Park North, 59th Ave. & Bethany Home Rd.
- 56b Bonsall Park South, 59th Ave. & Bethany Home Rd.
- 57 Chapparal Park, 57th Ave. & Greenbriar Dr.
- 58 Hidden Meadows Park, 76th Ave. & St. John Rd.
- 59 Northern Horizon Park, 63rd Ave. & Northern Ave.
- 60 O'Neil Park, 64th Ave. & Missouri Ave.
- 61 Orangewood Park, 72nd Ave. & Orangewood Ave.
- 62 Paseo Racquet Center & Park, 63rd Ave. & Thunderbird Rd.
- 63 Rose Lane Park, 51st Ave. & Marlette Ave.

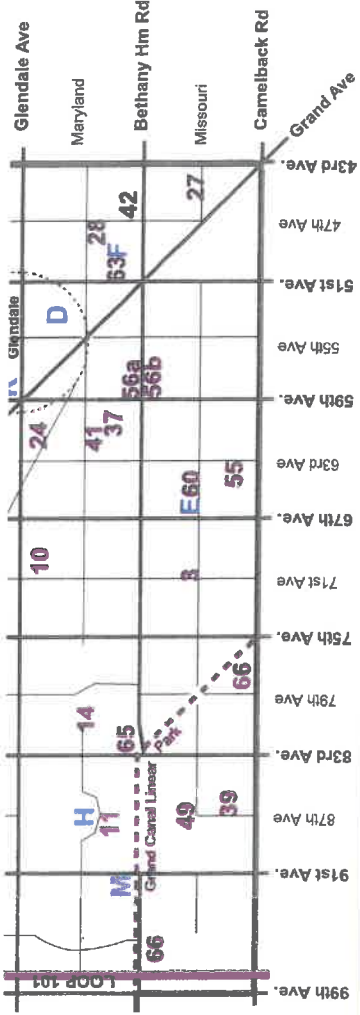

Parks	Acres & Amenities	Parks	Acres & Amenities	Parks	Acres & Amenities
1 Acoma	3.3	28 Maryland Lakes	6.0	55 Windsor	1.0
2 Arrowhead Lakes	5.0	29 Memmingen	3.0	56a Bonsall (north)	10.0
3 Bicentennial	5.0	30 Mission	4.5	56b Bonsall (south)	7.0
4 Butler	5.0	31 Mondo	5.2	57 Chapparal	12.0
5 Carmel	5.0	32 Montara	5.3	58 Hidden Meadows	10.0
6 Cholla	5.7	33 Murphy	2.5	59 Northern Horizon	40.0
7 Clavelito	5.0	34 Myrtle	1.0	60 O'Neil Park	11.0
8 Country Gables	4.0	35 New World	8.0	61 Orangewood	5.0
9 Delicias	5.0	36 Oasis	5.6	62 Paseo Racquet Center	23.0
10 Desert Garden	6.6	37 Ocotillo Rose	2.2	63 Rose Lane	19.0
11 Desert Mirage	7.4	38 Orangewood Vista	10.0	64 Foothills	40.0
12 Desert Rose	7.0	39 Pasadena	3.0	65 Glendale Heroes	81.0
13 Desert Valley	6.0	40 Paseo Neighborhood	3.0	66 Grand Canal Linear	24.3
14 Discovery	9.1	41 Plaza Rosa	0.2	67 Sahuaro Ranch	80.0
15 Dos Lagos	5.7	42 Rovey	0.4	68 Skunk Creek Linear	70.0
16 El Barrio	0.4	43 Sands	5.6	69 Thunderbird Paseo	55.0
17 Gardenwood	1.5	44 Sierra Verde	8.0	70 Thunderbird	1185
18 Greenbriar	3.0	45 Sonorita	1.0		
19 Greenway Granada	6.7	46 Sunnyside	8.0		
20 Heritage	3.3	47 Sunset	3.6		
21 Hillcrest	8.0	48 Sunset Palms	8.0		
22 Horizon	5.0	49 Sunset Ridge	10.0		
23 Kings	5.0	50 Sunset Vista	5.0		
24 Lawrence	2.9	51 Sycamore Grove	5.0		
25 Lions	4.2	52 Tarrington Ranch	5.0		
26 Manistee Ranch	4.3	53 Tierra Buena	5.0		
27 Mary Silva	5.0	54 Utopia	3.0		

Legend

- Ballfield
- Soccer/football field
- Tennis
- Volleyball
- Playground
- Picnic Tables
- Grills
- Dog Park
- Splash Pad
- Trails
- Restrooms

2 Indicates Number of Ramadas

Lighted sports facilities:

• If more than one field or court, number is on icon